

## Hinge Door&Inline Panel-Recess

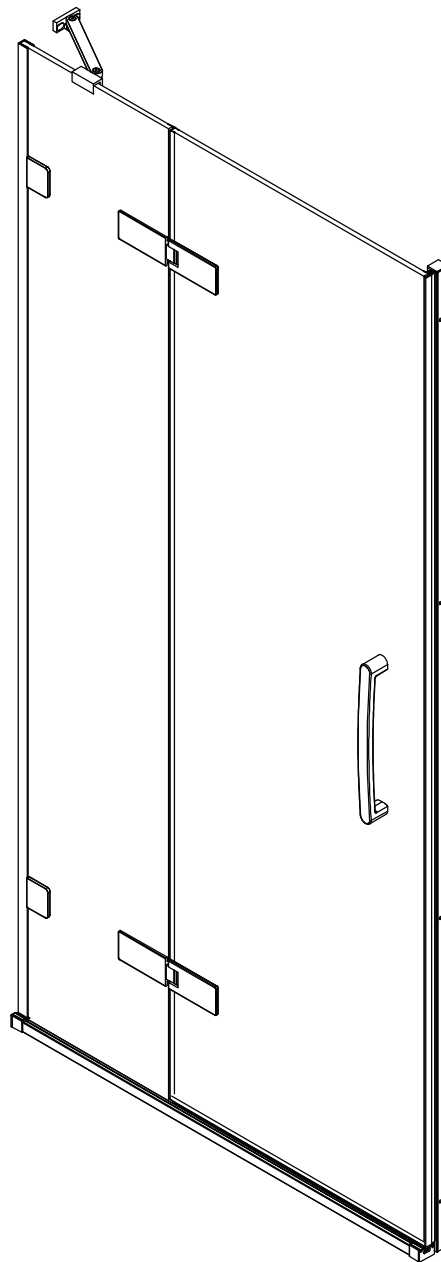

## INSTALLATION GUIDE

**IMPORTANT: Please read the complete instructions before commencing fitting.**

Make sure the tray is 100% level in all directions.

Check that you have the tools required. ☐

Check the installation site is compatible with the sizes of door supplied. ☐

Check all the enclosure components are present. ☐

Check the installation kit is complete. ☐

Do Not attempt to install the product unless you can tick all 4 boxes satisfactory.

The wall plugs supplied with the installation kit are for use in solid walls. Hollow or 'stud partition' walls will require alternative fixings. Please consult a hardware supplier for the correct type.

**ATTENTION: TAKE EXTREME CARE WHEN HANDLING GLASS, WEAR PROTECTIVE EYEWEAR AND CLOTHING. DO NOT LEAVE THE GLASS ON HARD SURFACES AND AVOID CONTACT BETWEEN THE GLASS EDGES AND HARD SURFACES OR IMPACTS DURING THE INSTALLATION.**

## Fixing kit components



Note: Extra components have been supplied to make this product suitable for left or right hand configuration and therefore some parts will be surplus to requirements.



MGVC08AL

1



MGVC08AR

1



MGVC09L

1



MGVC09R

1

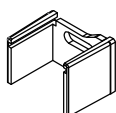

MGVC21L

1

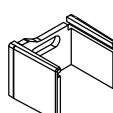

MGVC21R

1

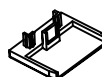

MGVC13A

1



MGVC14A

1



MGST5X65

4

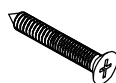

MGST4X30BH

6



MG8x51PLUG

x4



MG6x30PLUG

x6



ST4 20

5

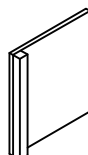

MGVC45  
Installation tool

1

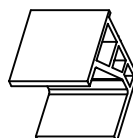

MGVC19A

2



MGVC20A

4

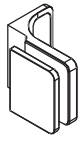

IRF6003-1  
x 2



MGCAP  
x 2



MGCOVPLT  
x 2

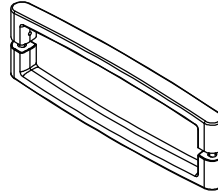

MGVC27  
1

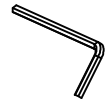

8S1300511  
1

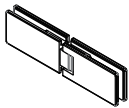

MG3DL2143  
x 2



A06S0046  
2



MGCAP  
x 8

SP010SP281000

Door assembly tool

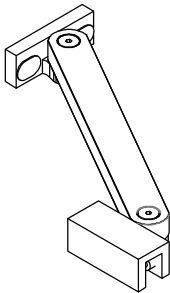
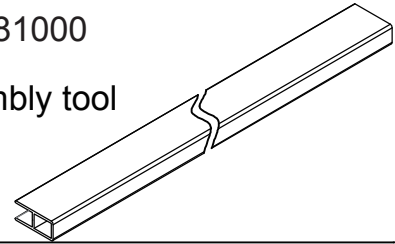

SP08SCU12320  
1

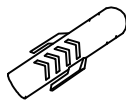

MG6x30PLUG  
x2

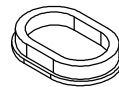

Cover cap  
x2

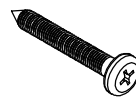

B-head  
ST4 30  
2

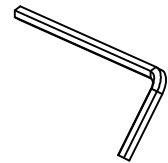

A06S0046

## Tools required

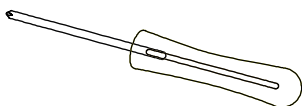
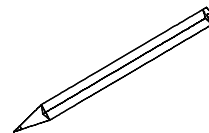
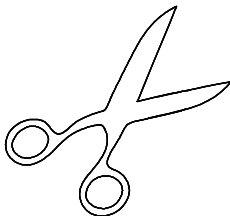
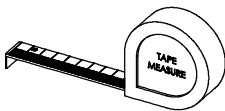

PH2

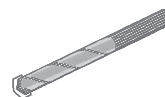
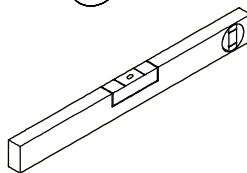

! 6&8



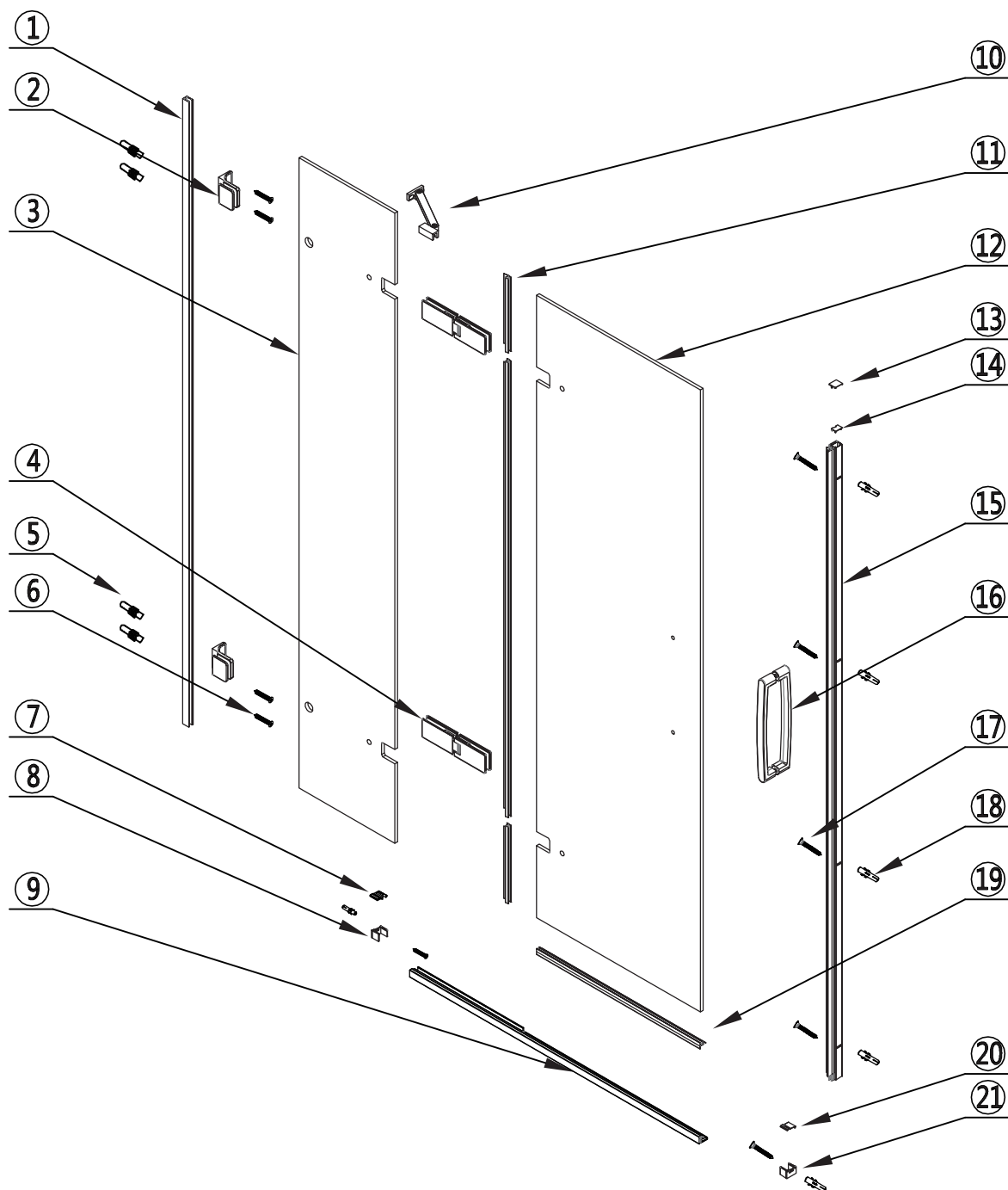

No.	QTY	Part No.	No.	QTY	Part No.	No.	QTY	Part No.
①	1	MGVCWPSET	⑧	1	MGVC21L/R	⑮	1	MGVCAPSET
②	2	IRF6003-1	⑨	1	GHKA	⑯	1	MGVC27
③	1	GMGHFA	⑩	1	SP08SCU12320	⑰	6	MGST4X30BH
④	2	MG3DL2143	⑪	1	MGVC44LSET/RSET	⑱	6	MG6x30PLUG
⑤	4	MG8x51PLUG	⑫	1	Door panel	⑲	1	MGVC30A
⑥	4	MGST5X65	⑬	1	MGVC13A	⑳	1	MGVC09R/L
⑦	1	MGVC08AL/R	⑭	1	MGVC14A	㉑	1	MGVC21R/L



## Step 1

**IMPORTANT!**  
Whether fitting on a tray or on a tiled  
Wetroom the tray or floor must be 100% level !

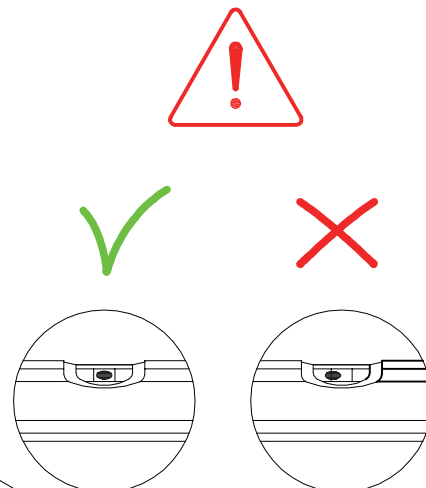
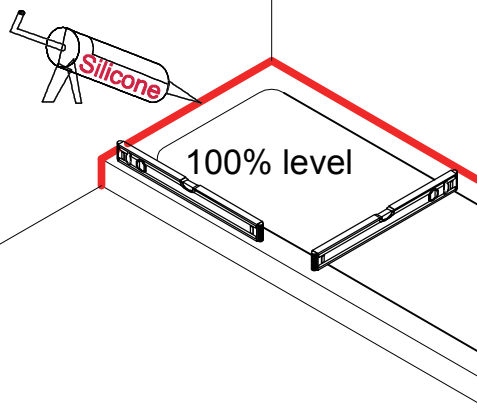

## Step 2

Mark 64 mm in from the edge of the tray.

Hinge fixing side only

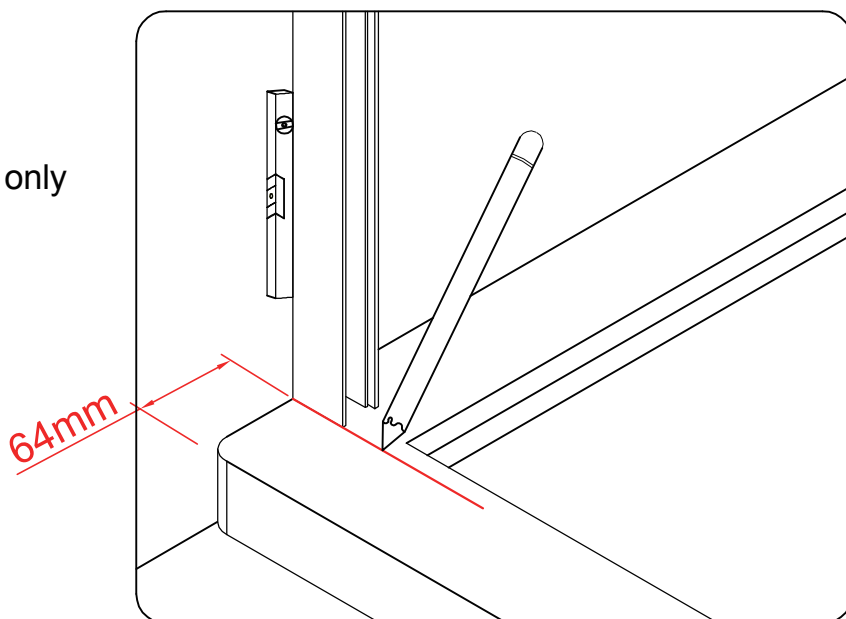

### Step 3

Note the position of the labels on the wall profile. Make sure Label 'T' is to the top and 'B' is to the bottom. Line up the outside edge of the profile with the mark and plumb vertical. Mark the wall through the pre-drilled holes.

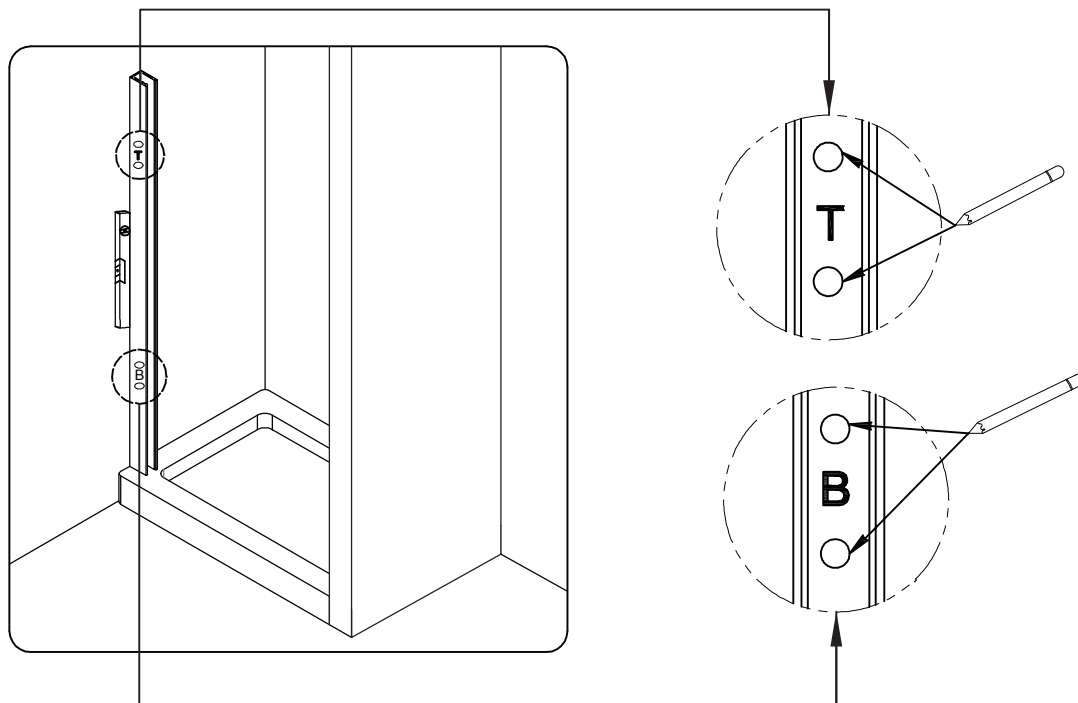

**NOTE:** Do not fix wall profile.

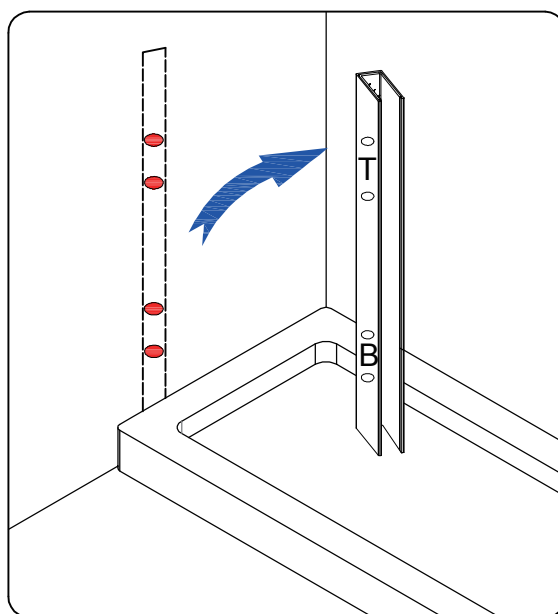
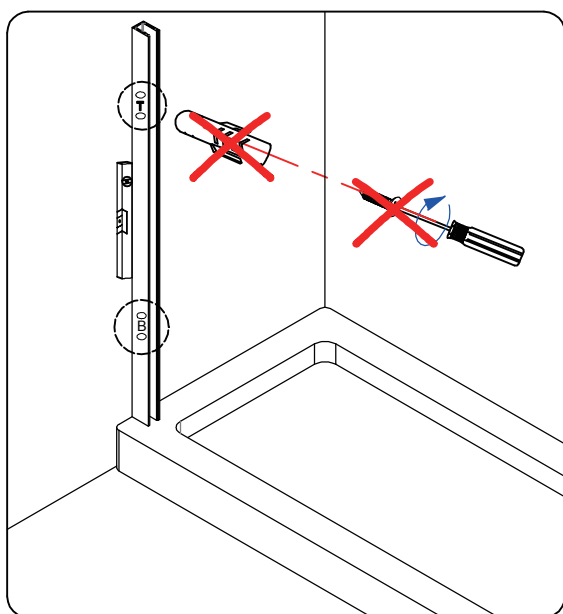

## Step 4

Remove profile and drill holes for wall brackets with diameter 8mm masonry bit and insert wall plugs. Ensure wall plugs are flush with tile. Repeat for each wall fixed panel.

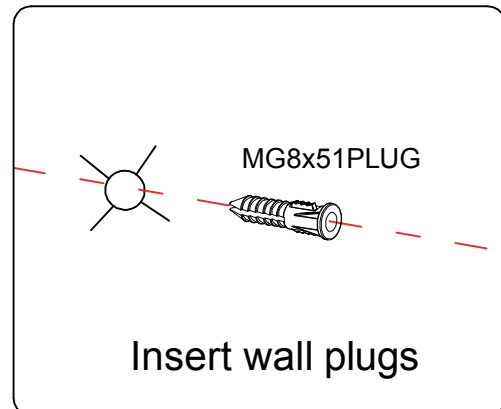
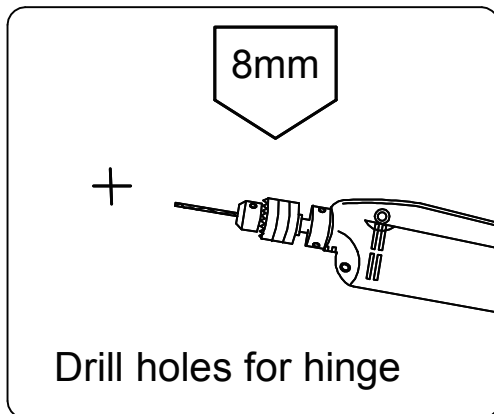

## Step 5

Position brackets 8mm inwards from edge of tray Mark wall through slot. Drill 6mm diameter hole centre of slot and fix bracket both sides.

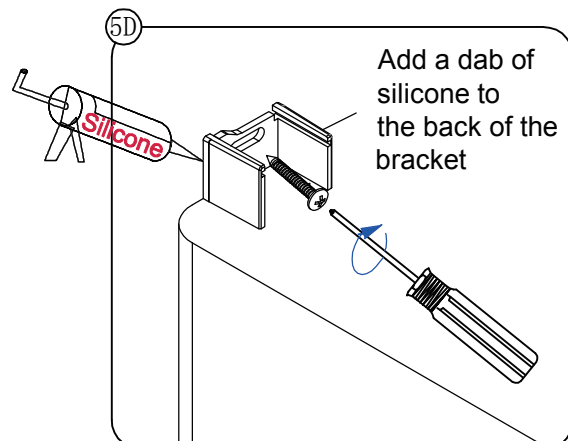
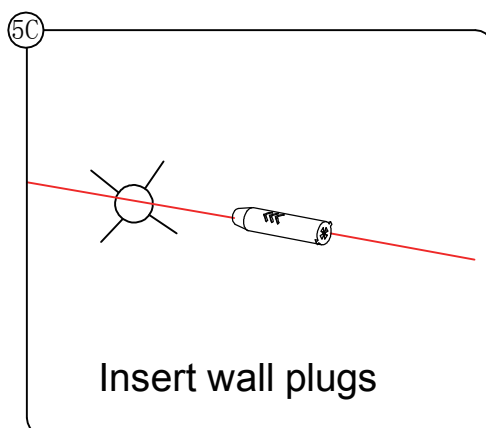
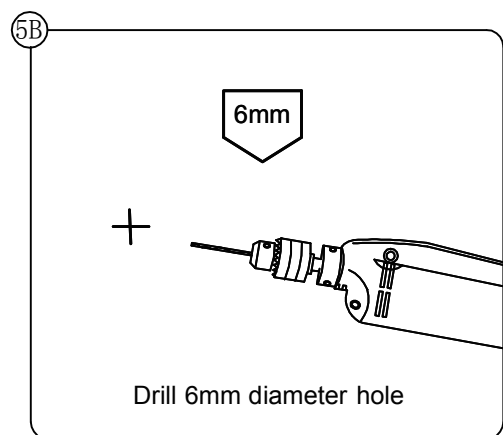
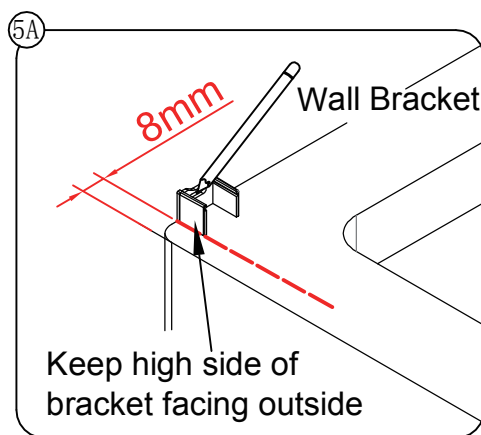

## Step 6

Insert track into brackets keeping beveled face to inside. Fit brackets to end of track.

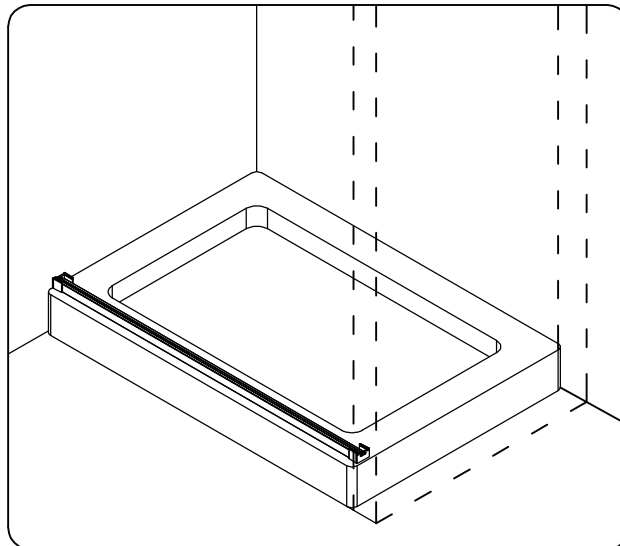
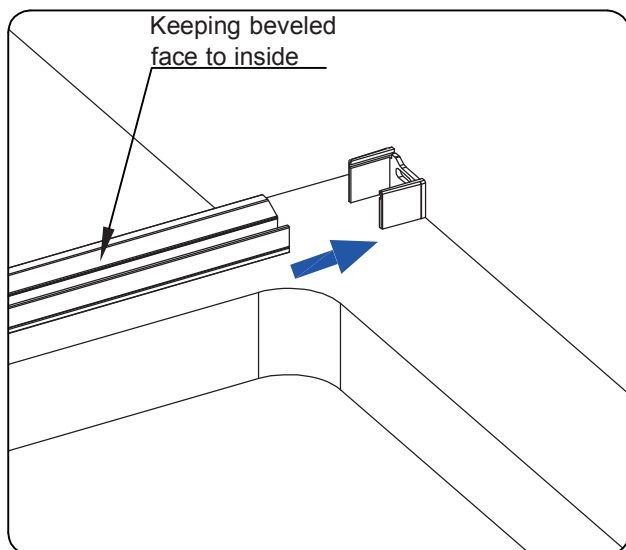

## Step 7

Slide caps into position. To the door side fit cap shown in 7A, for fixed panel side use cap shown in 7B.

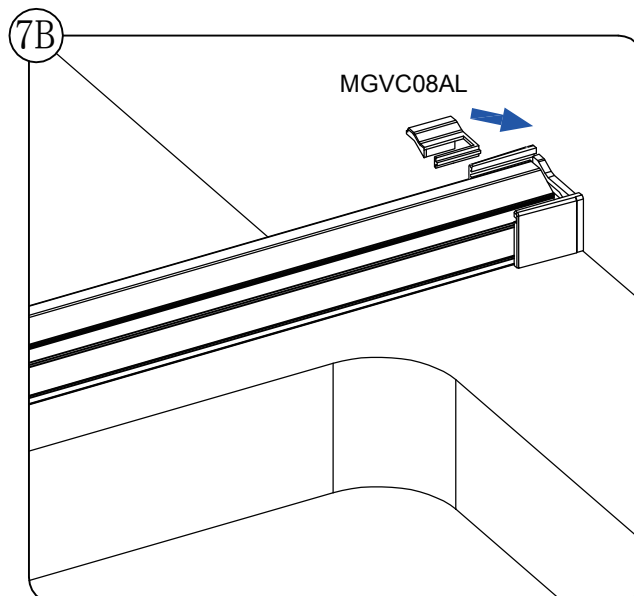
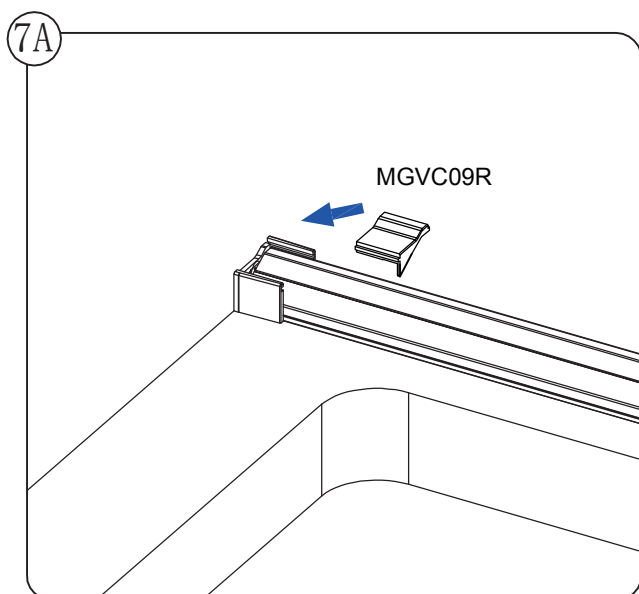

## Step 8

Before assembling the brackets to the fixed panel make sure it is orientated the correct way. Measure hole centres from top and bottom to determine correct orientation of panel.

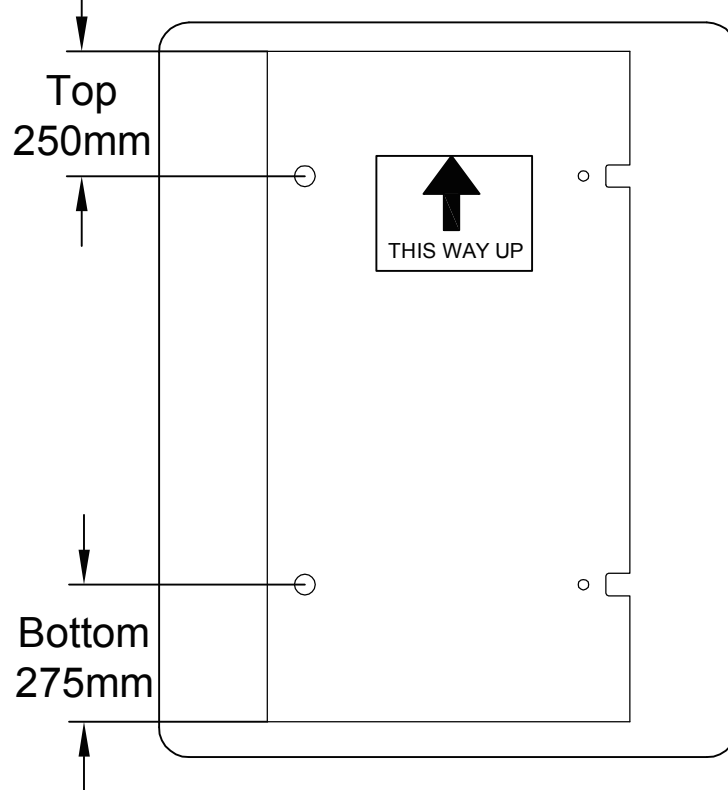

## Step 9

Push on wall profile completely ensuring end is flush with the top of the glass panel.

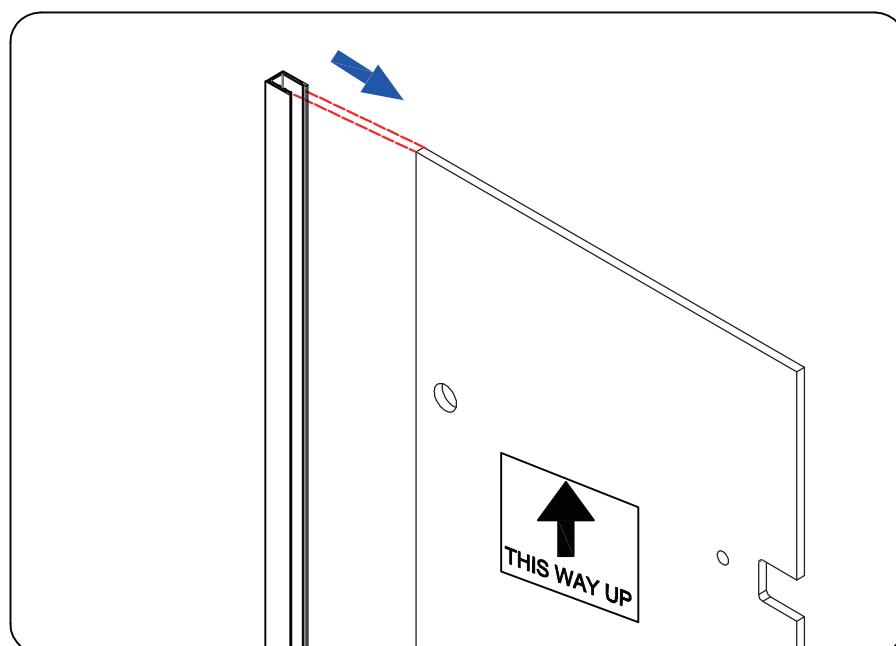

## Step 10

Fix wall brackets loosely ensuring fixing holes are to the inside of glass panel.

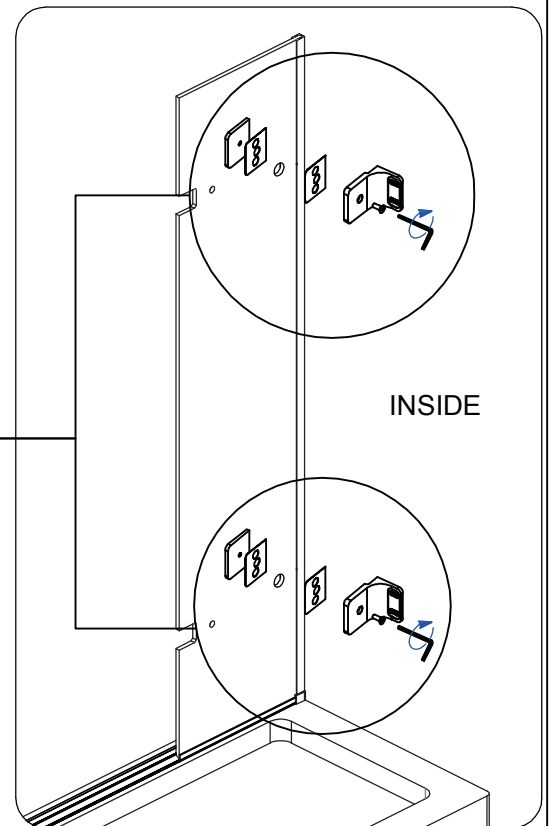
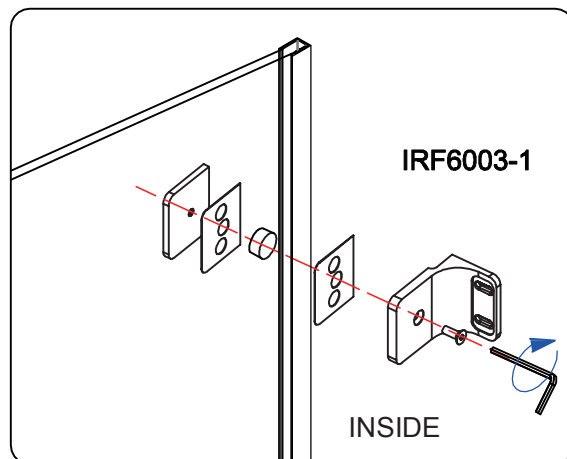

## Step 11

Take fixed wall panel and insert into bottom track keeping outside edge of glass panel tight to end of angled profile in bottom track. Make sure there is no gap between the edge of the glass and the angled profile.

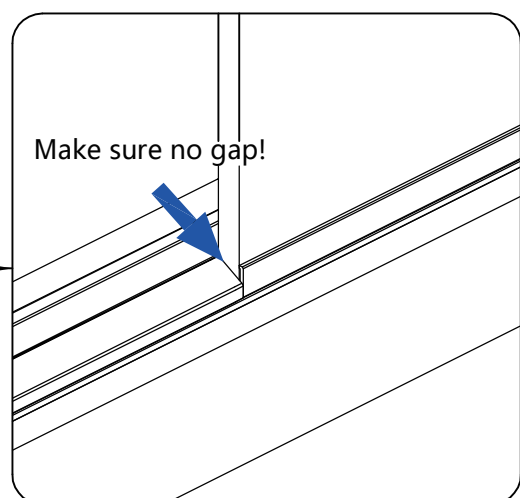
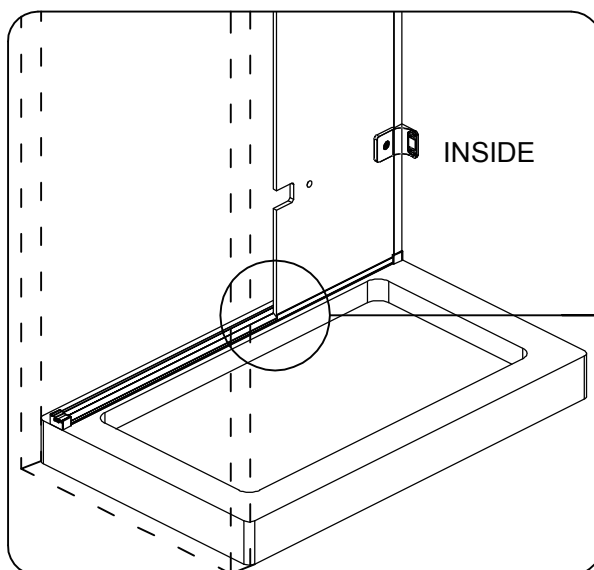

## Step 12

Fix wall brackets to the pre drilled holes. Do not fully tighten, leave enough slack for adjustment. Secure top bracket first.

Note: Hold glass panel and gently tap profile back tight against wall using MDF tool provided, working from bottom to top.

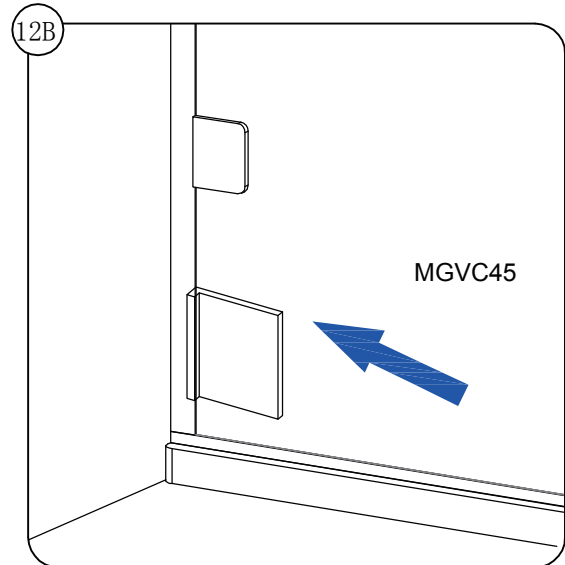
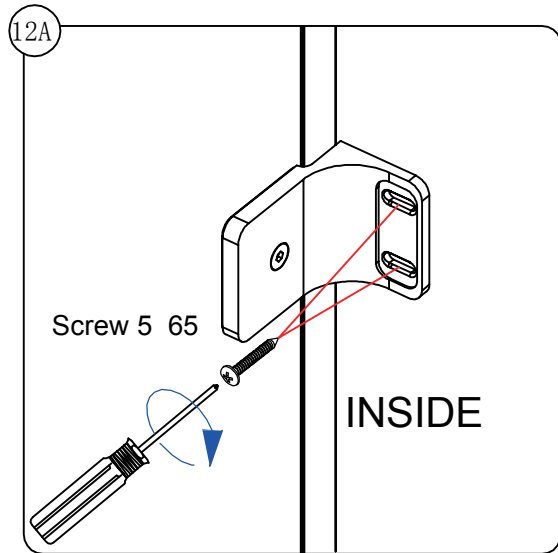

## Step 13

Check panel for level and fully tighten screws to wall.

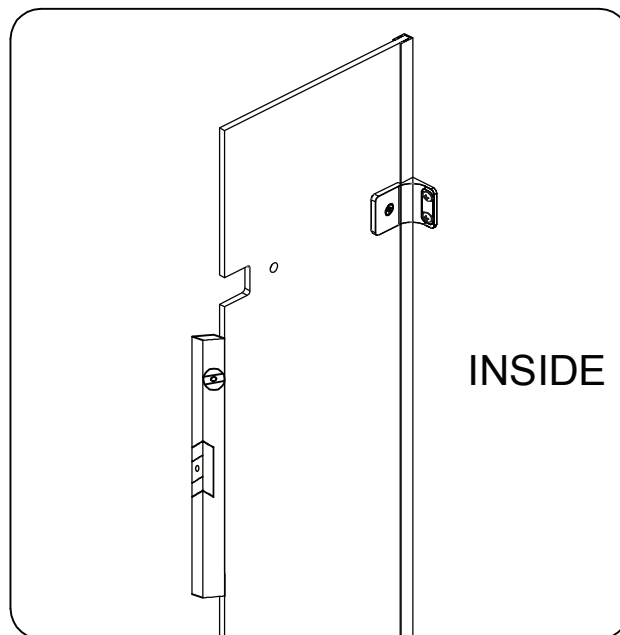

## Step 14

Do not fully tighten bracket to glass, leave enough slack for adjustment.

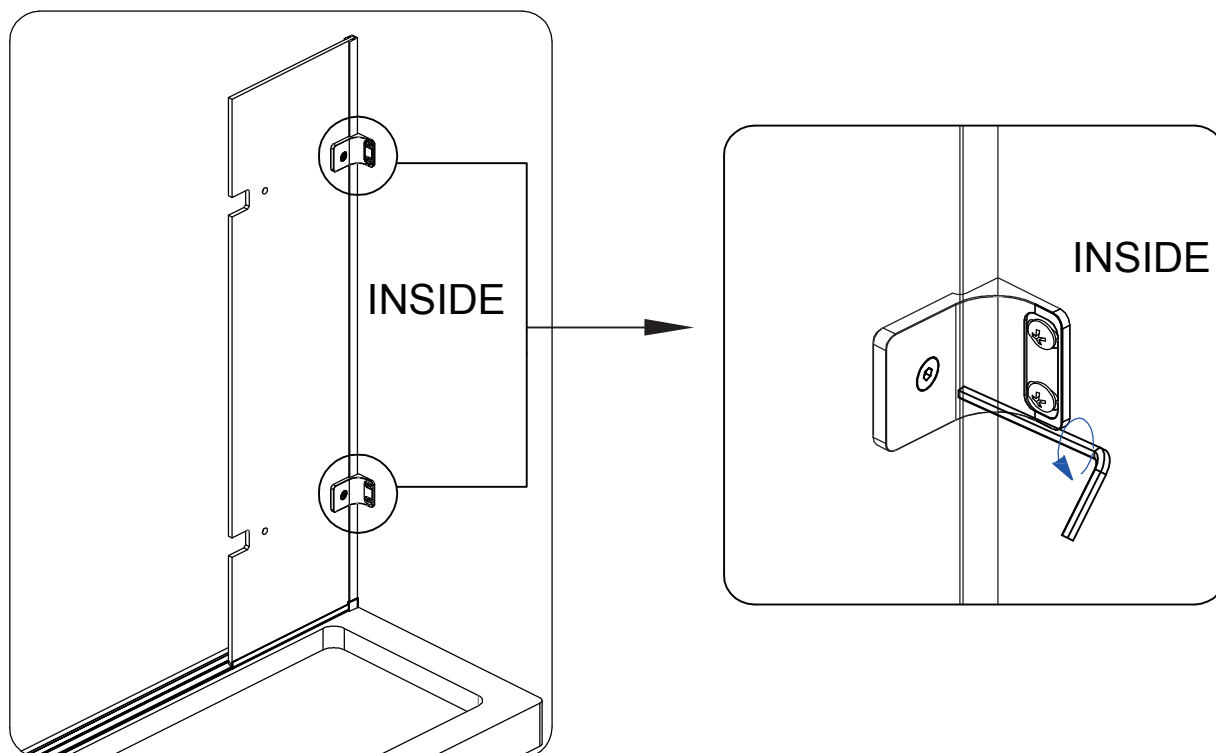

## Step 15

Fit hinges ensuring that the part of the hinge which has a cut out is fitted to the door.

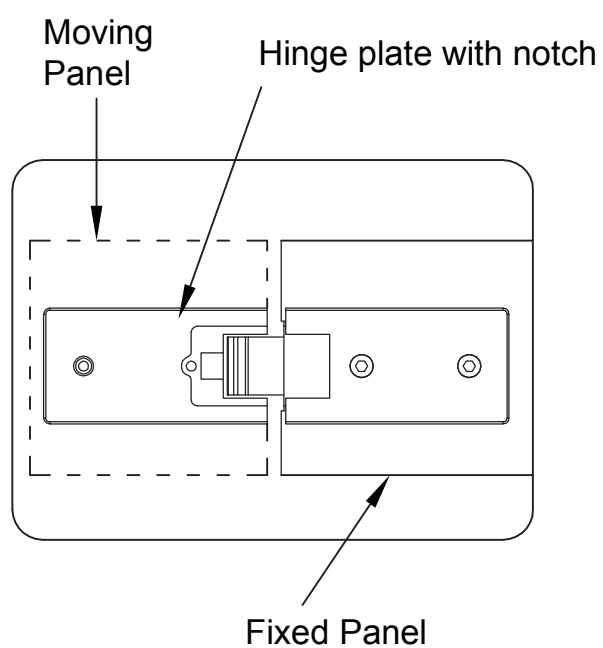



## Step 16

16A. The side of the hinge that has the fixing bolts must be to the inside of the moving panel. Hinge should be fitted in centre of cutout for maximum adjustment later. Fully tighten bolts.

16B. Tip : Use MDF tool for squaring hinges.

16C. Remove back plates from hinges on fixed panel side.

16D. Place hinge plate, washers, bolts and hex key inside enclosure.

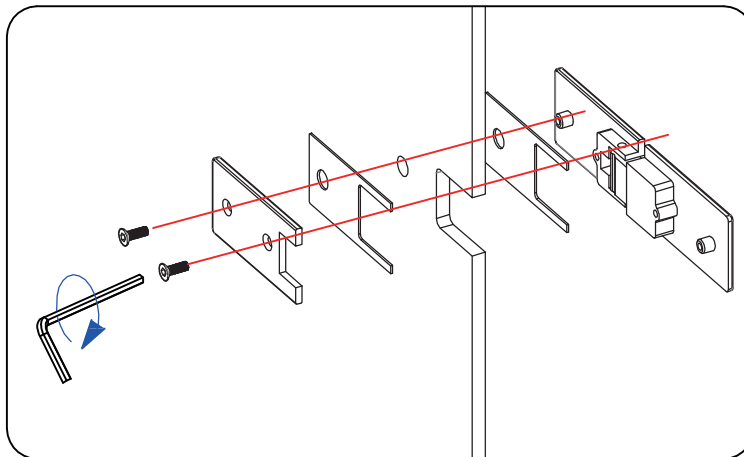

## Step 17

Check door opening at bottom and make sure that the distance at the top is the same.

Gap top and bottom  
should be width of  
moving panel +12mm

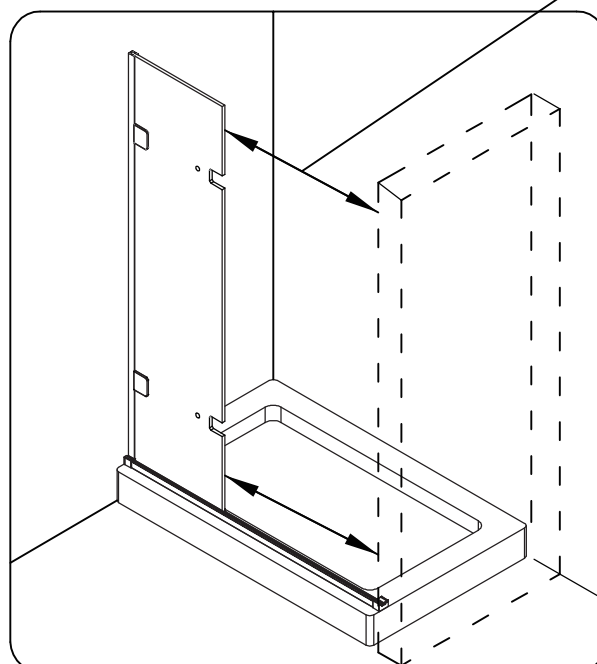

## Step 18

Place locating aids and spacers on threshold, one each side of opening.

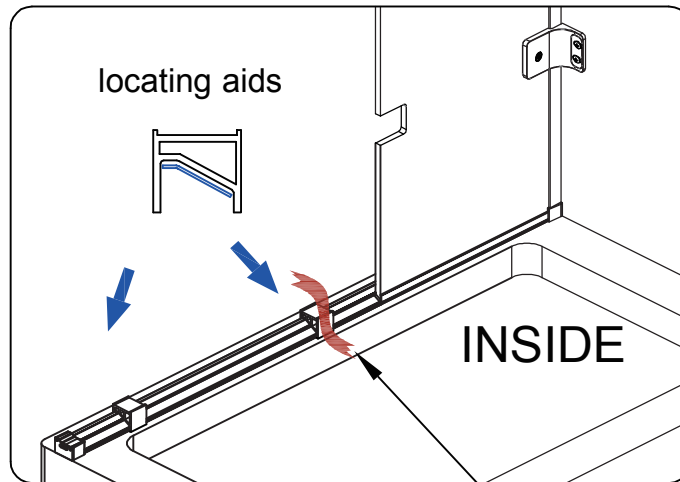

Tip! Hold both locating aids in position with masking tape.

## Step 19

The door should be lifted onto the locating aids standing inside the inside the enclosure. Make sure you have all the fixings and tools required inside the enclosure.

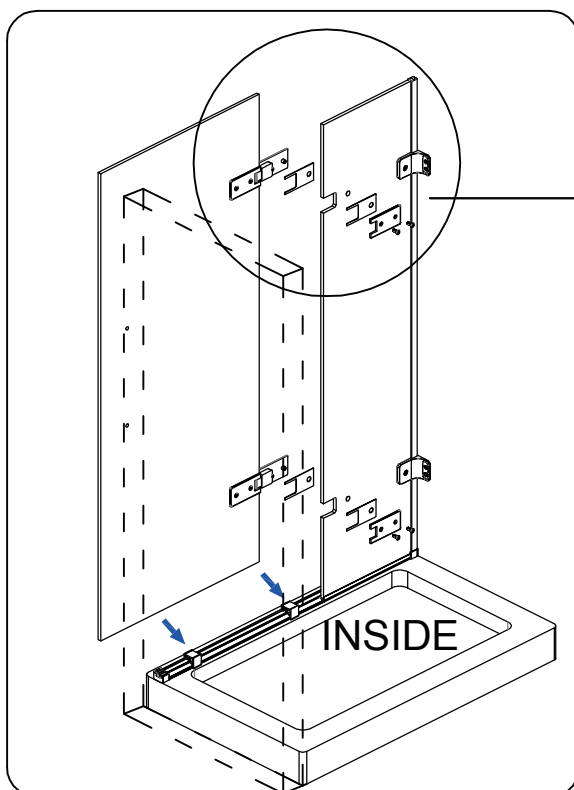

Use door assembly tool to hold the door in place until the hinges are fitted.

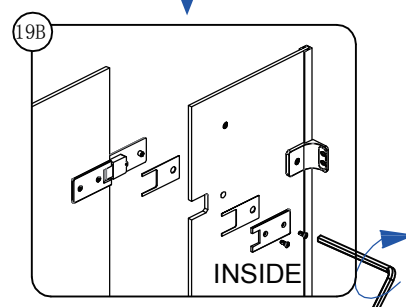
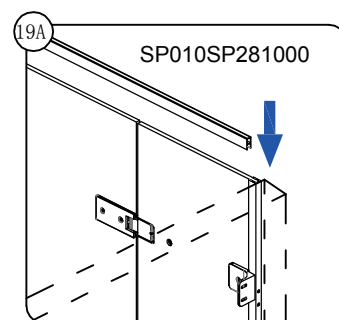

## Step 20

Loosely fix back plate to hinges ensuring washers are in position and hinges are level.

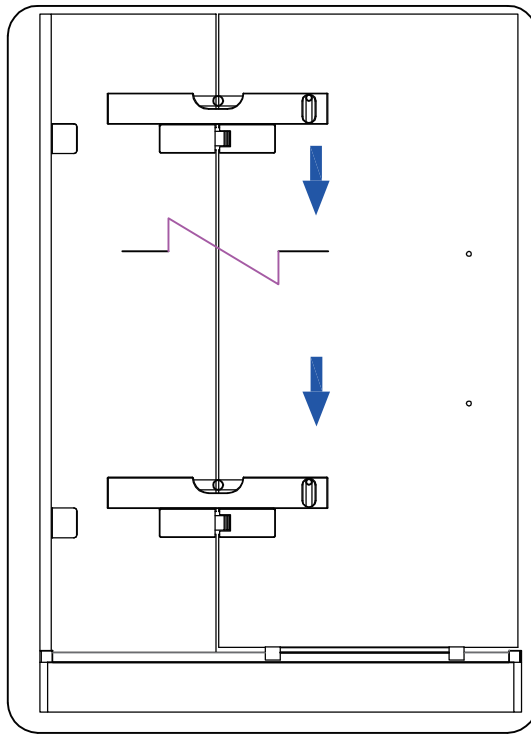

## Step 21

Ensure gap is equal top and bottom, then fully tighten hinge bolts.

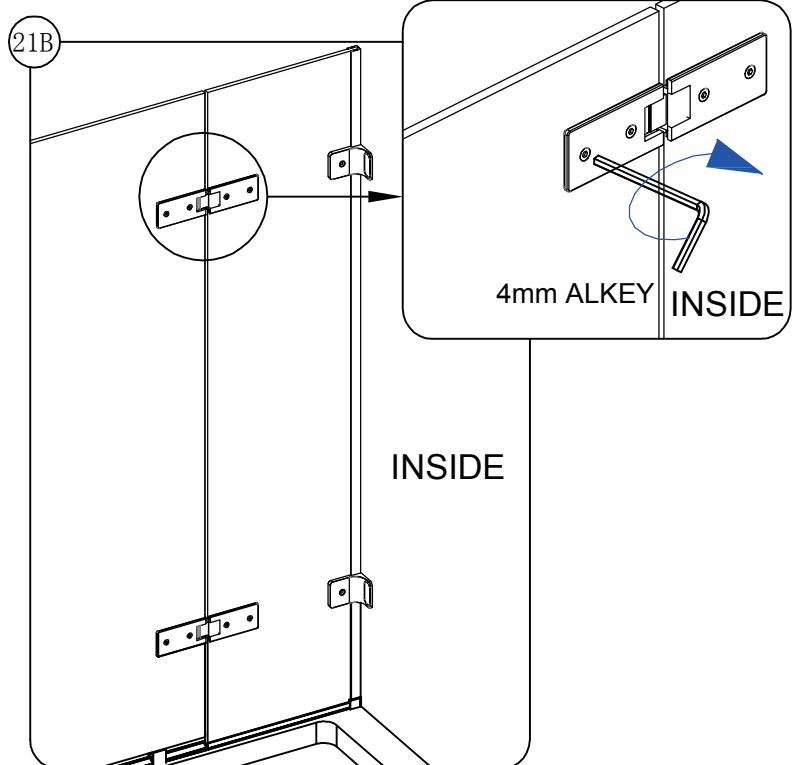
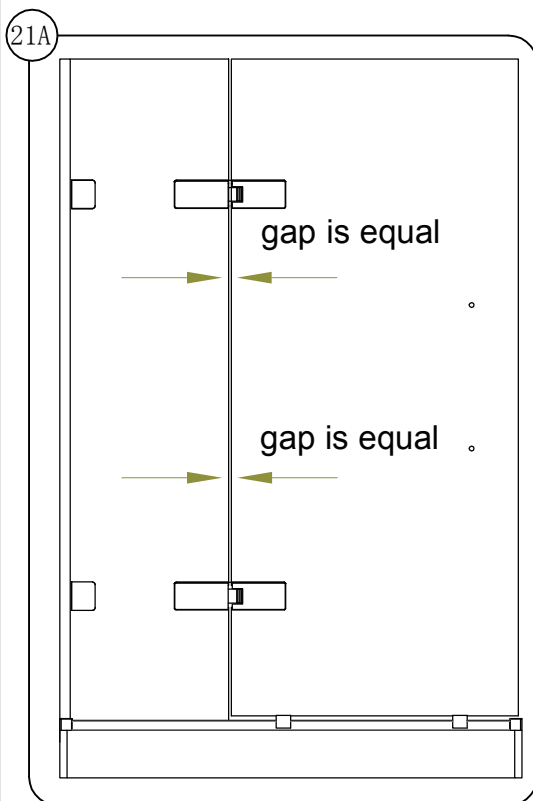

## Step 22

Remove spacers and check gap under moving panel is equal. If gap is not equal loosen hinges slightly and adjust. Use packer to check gap is correct height and even.

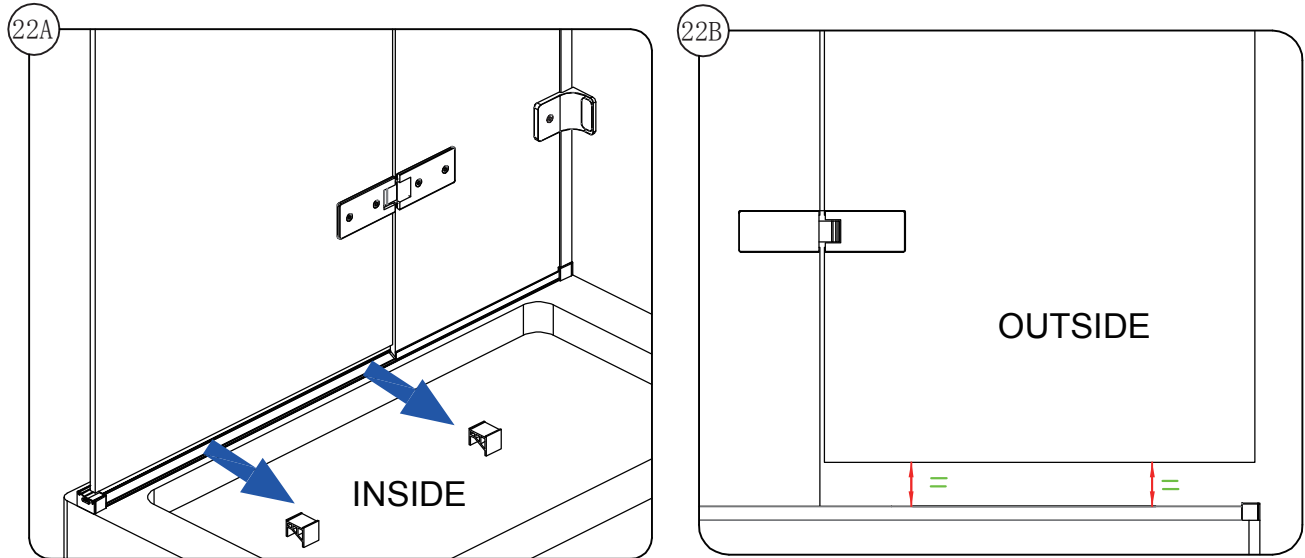

## Step 23

Left and right hand seal kits are provided, determine handing and use appropriate seal kit. Left hand model shown below. Push on longest seal between hinges onto back edge of moving panel. Take longer seal and fit to top keeping notch to hinge. Repeat with shortest bottom seal.

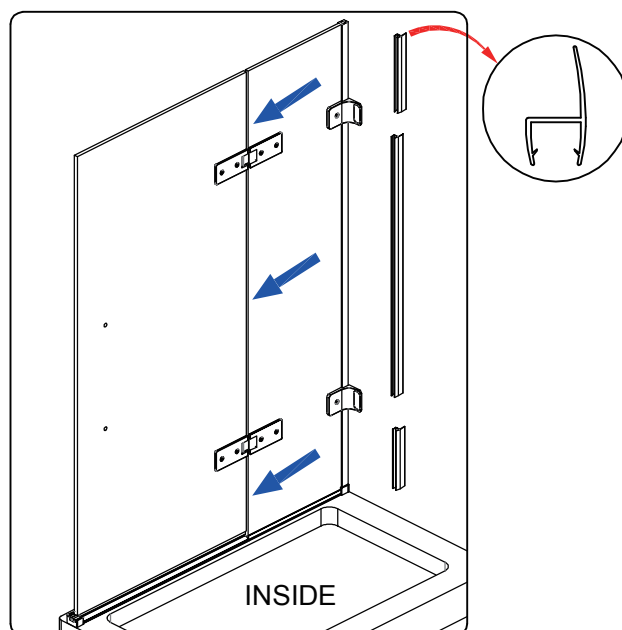

## Step 24

Fit bottom door seal keeping longest fin to inside. Notch fin where it meets the closing seal to ensure door closes fully.

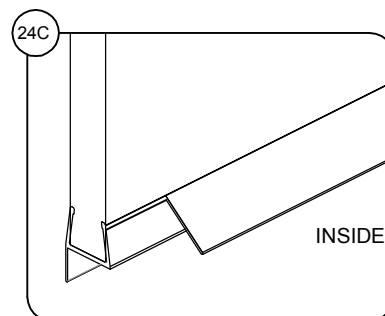
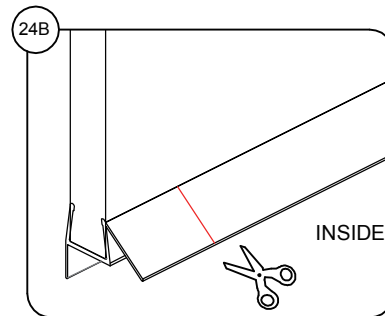
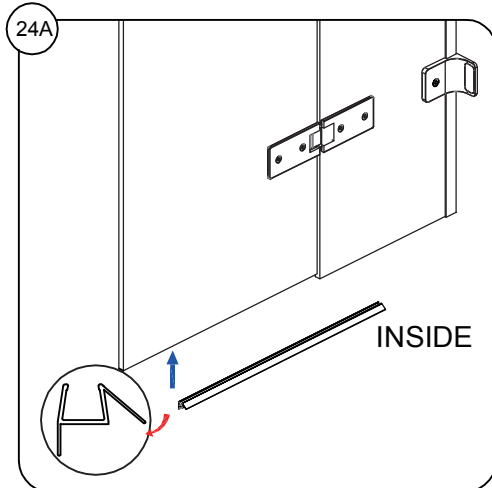

## Step 25

Take door closing post and place tight to inside of bracket.

**Note:** edge that receives bubble seal faces outwards.



Plumb door closing post and mark wall through pre drilled holes.

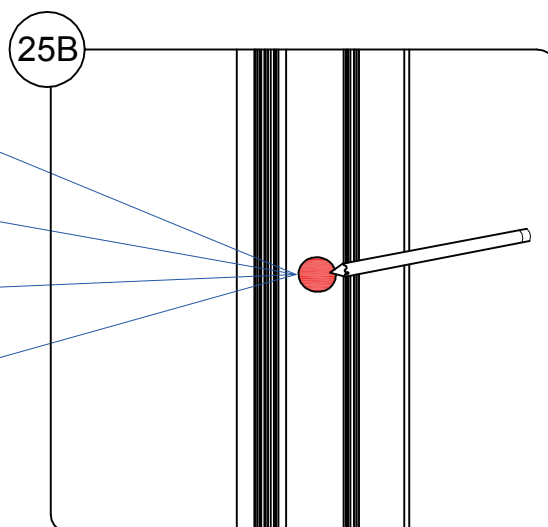
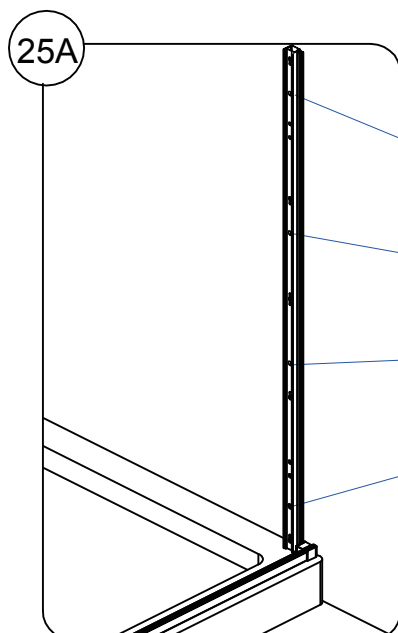

## Step 26

Remove profile and drill holes for wall brackets with diameter 6mm masonry bit and insert wall plugs. Make sure wall plugs are flush with tile.

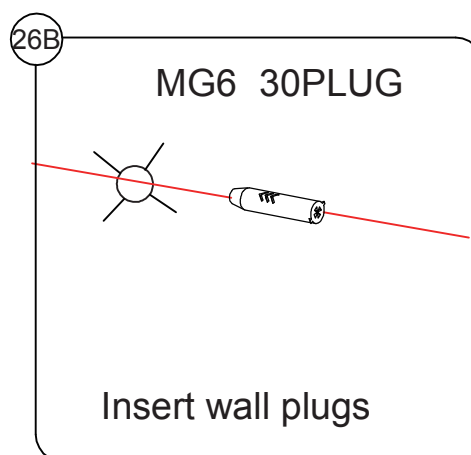
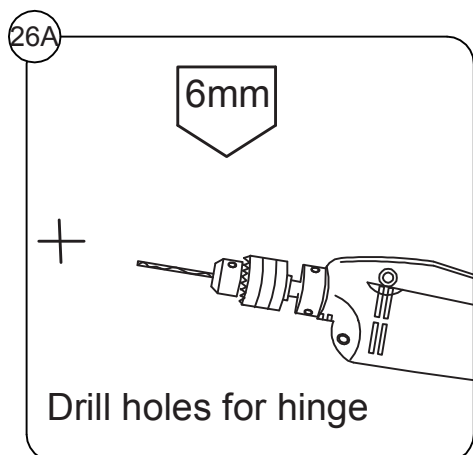

## Step 27

Fix closing post with screws 4 30mm through large hole in front of post through to the slotted hole in back of post.

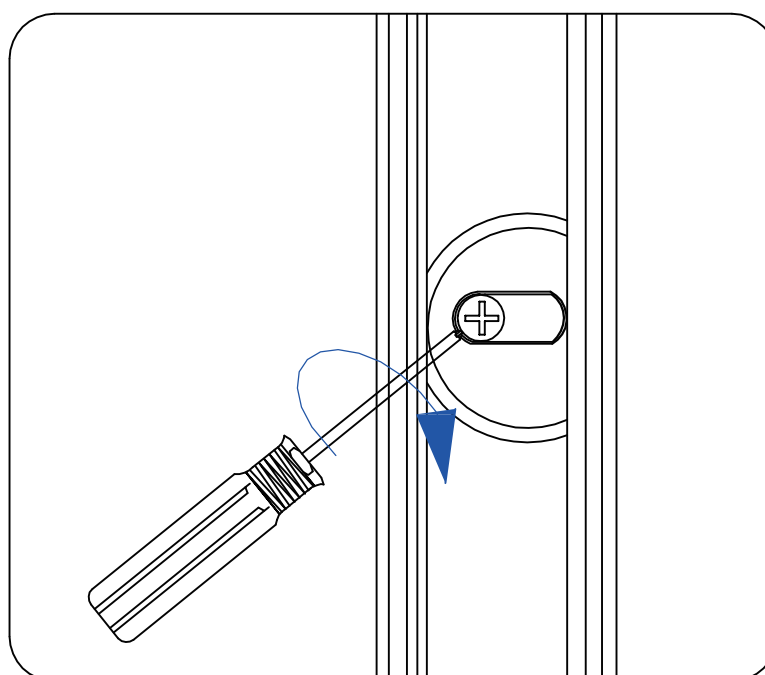

## Step 28

Fit bubble seal to post starting at the bottom and working to top. To help fit the upright seal lightly spray some water on the profile.

## Step 29

To align the seal on the closing post with door (adjustment B), loosen all the metal screws beside the plastic grub screws. Adjust the plastic grub screws while checking the door against the seal. Once the seal holds the door in the fully closed position tighten the metal screws. Ensure the seal holds the door evenly from top to bottom.

**Note:** If profile is at max adjustment use longer adjusting screws provided.

Adjustment A can be changed by loosening the fixing screws and moving post, then tighten screws.

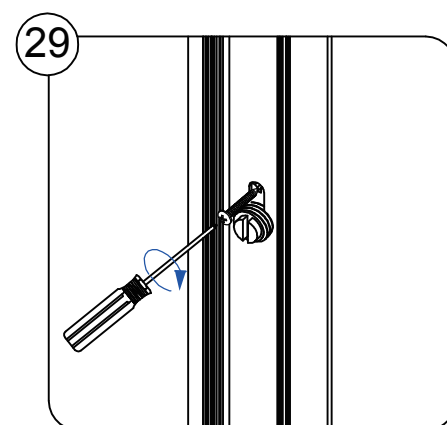
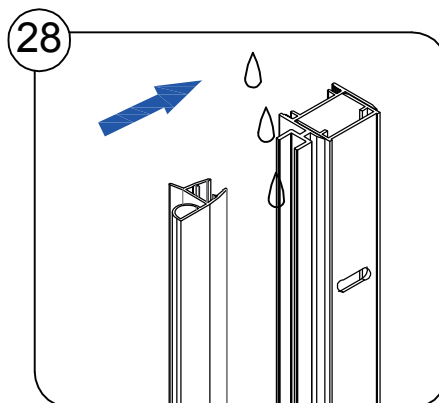
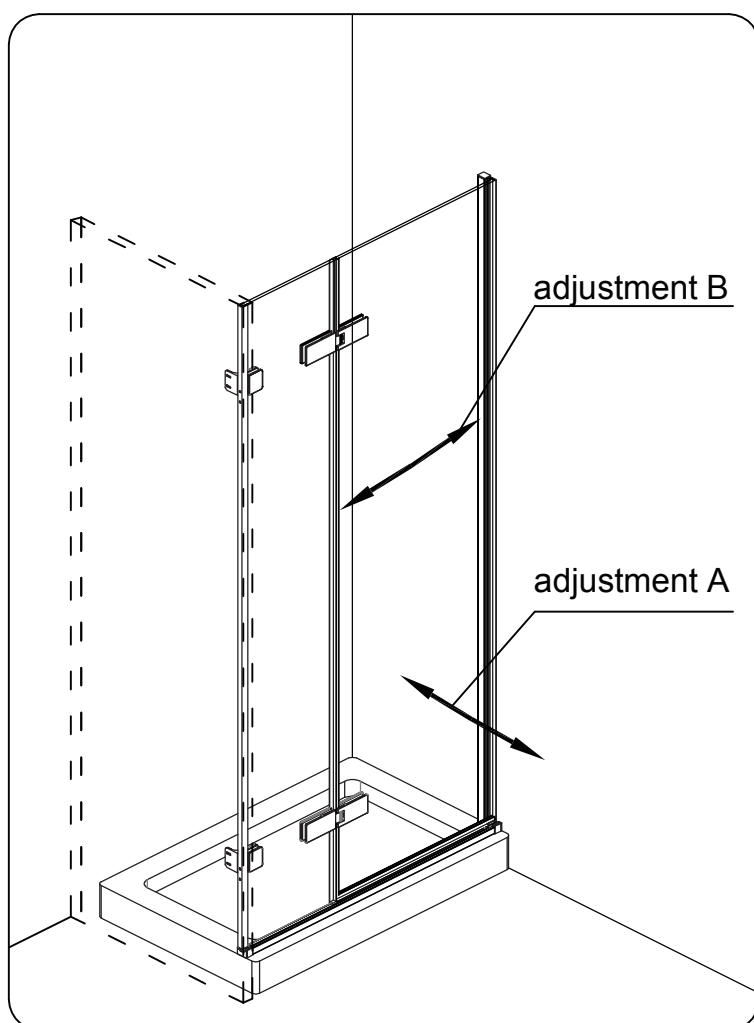

### Step 30

Fit the cover profile to the closing post starting at the bottom by pressing firmly into position work from bottom to top.

### Step 31

Fit caps **MGVC13A** and **MGVC14A** to the the top of the closing profile.

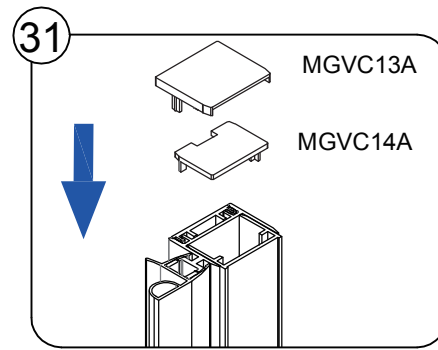
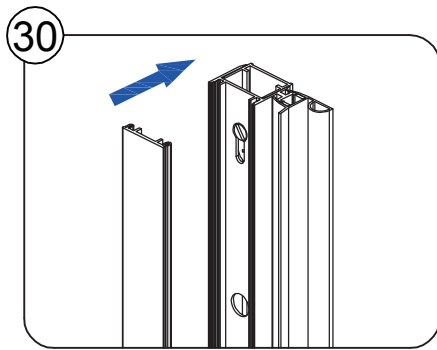

### Step 32 Fix the handle and top rail.

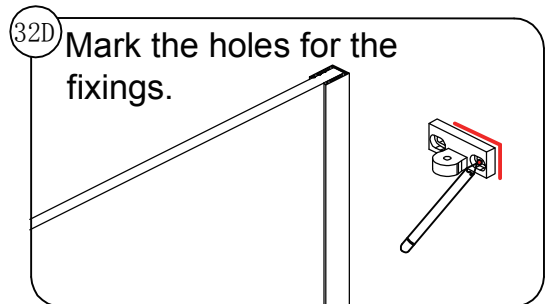
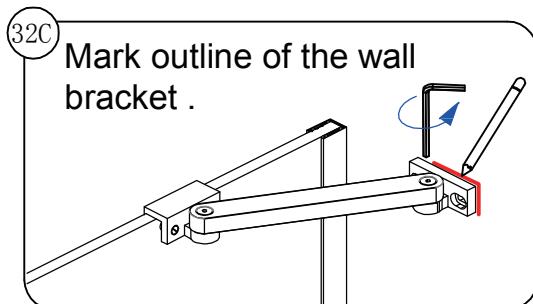
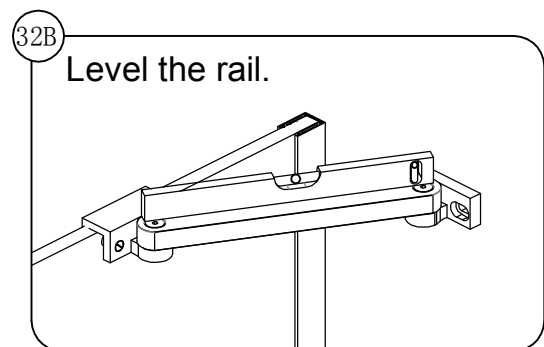
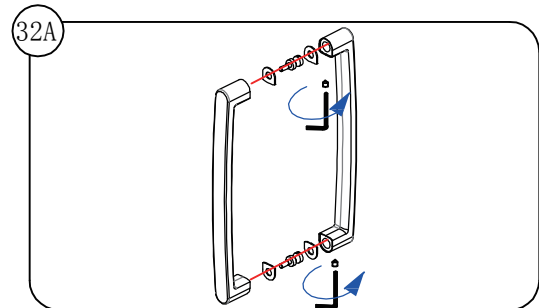
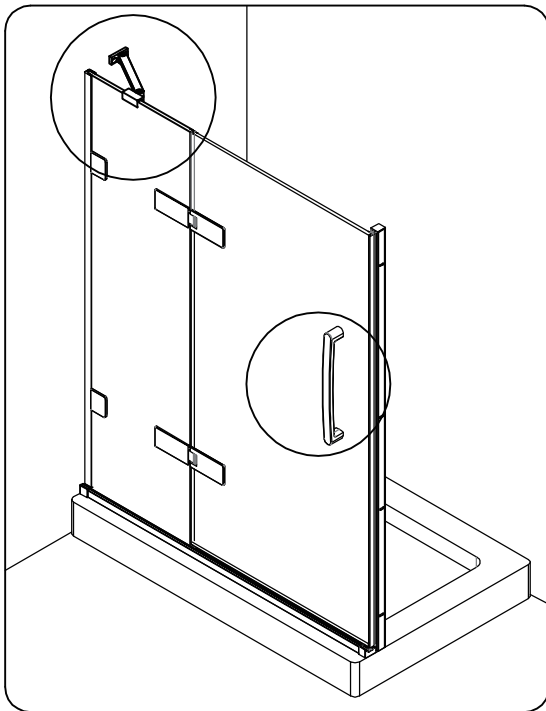



32E

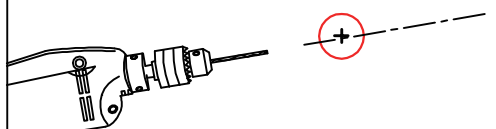

Drill with 6mm masonry  
drill bit

32F

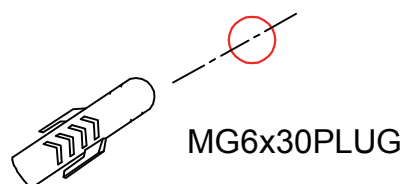

MG6x30PLUG

32G

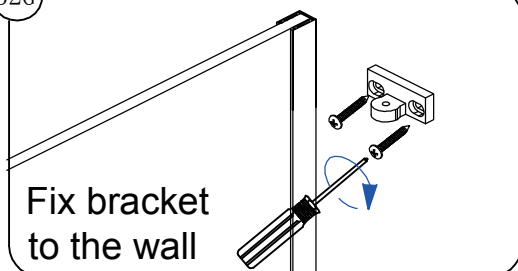

Fix bracket  
to the wall

32H

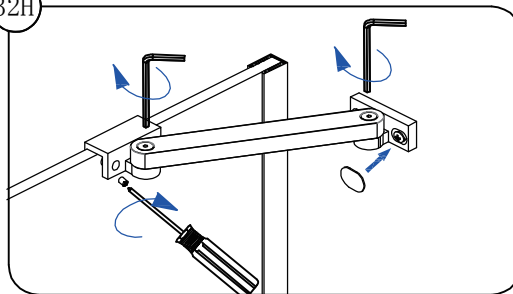

### Step 33 Additional adjustment

Where an angled bracing bar is fitted additional adjustment can be made by:

- 1) Loosen the 2 screws clamping the glass.
- 2) Move the glass panel in the direction required(see arrow).
- 3) Tighten the 2 screws.

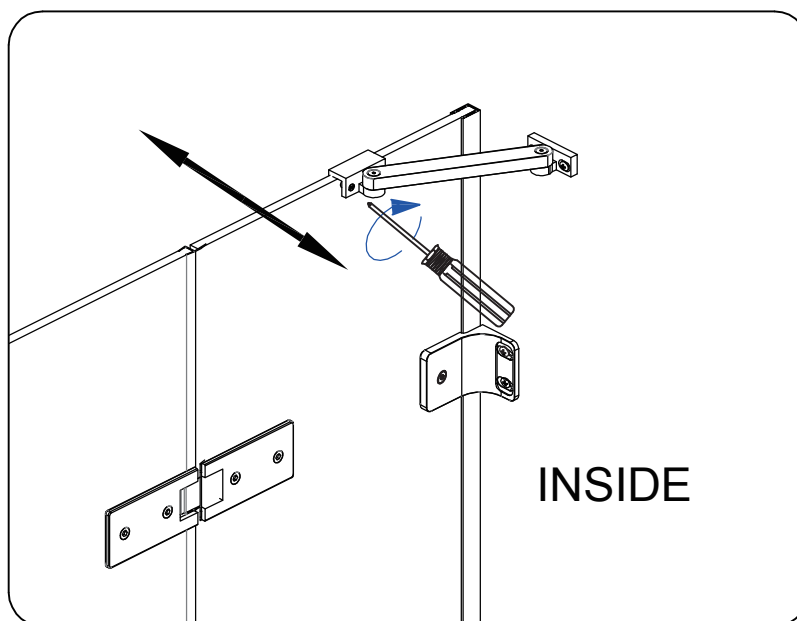

### Step 34 Adjusting fixed panels

If after fitting you still need adjustment to align doors etc ,you can achieve this by loosening the screws fixing the bracket to the wall and the bolts clamping the bracket to the glass.

Adjust the panels until the desired fit is achieved. Fully tighten all fixings.

**Note:** If no further adjustment is needed make sure all fixings have been tightened securely. 

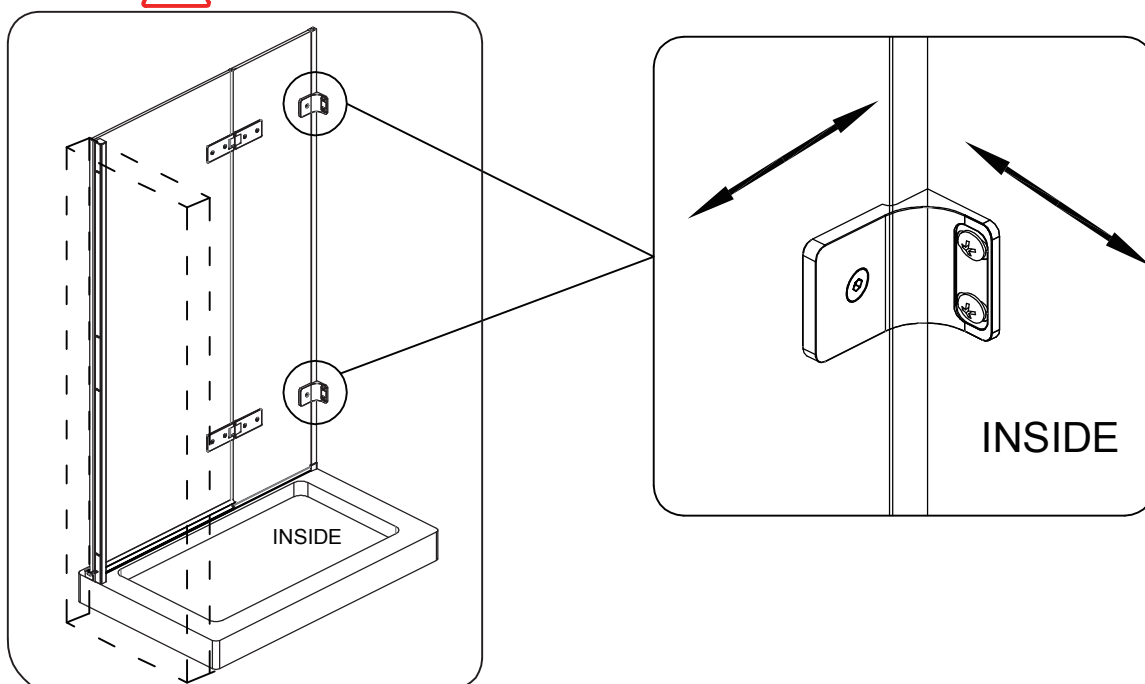

### Step 35 Fitting cover caps.

Fitting cover caps. Peel off protective strip to adhesive tape to back of cap and firmly press in position .

Tip : We recommend that you place a dab of silicone to the back of the cover caps at each end of the tape.

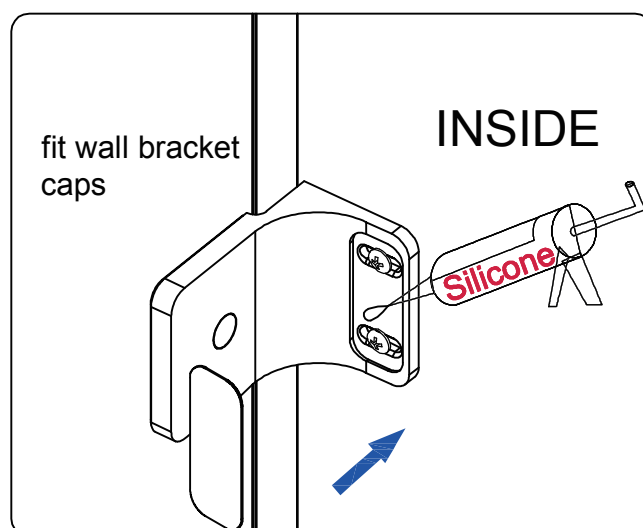

### Step 36 Sealing your enclosure.

**Make sure all surfaces are thoroughly cleaned and dry before applying sealant.**

Only seal the outside of the enclosure (red line). Do not seal the inside.  
Seal vertically along the wall, along the outside edge of the bottom profile and any joints in the profile, including where the bottom track meets the end brackets

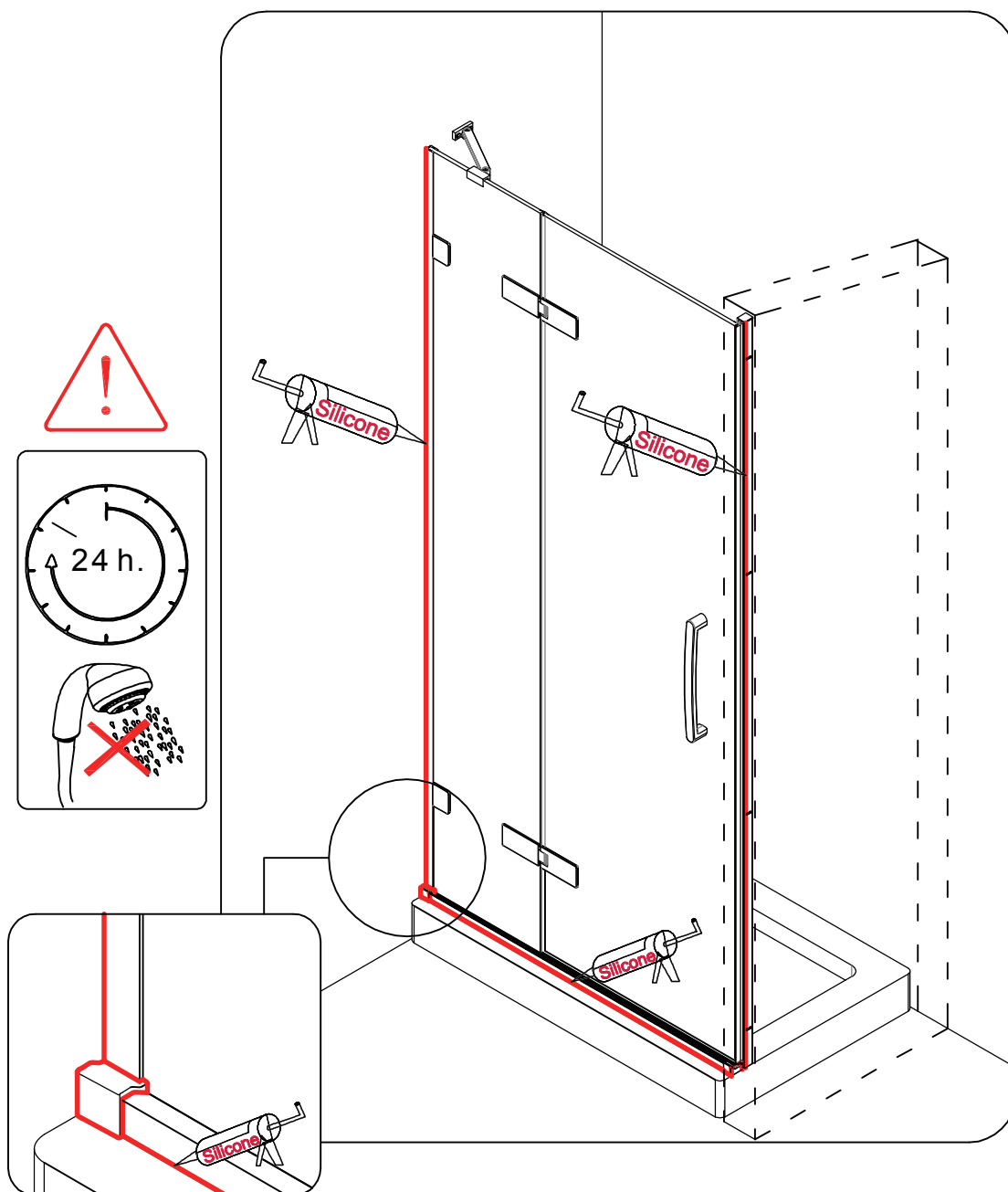

[www.merlynshowering.com](http://www.merlynshowering.com)

## MERLYN

Merlyn Showering  
Unit 8, Purcellsinch Industrial Park,  
Dublin Road, Kilkenny, Ireland.  
Tel: 00353 56 779 1555  
Fax: 00353 56 779 1576  
[www.merlynshowering.com](http://www.merlynshowering.com)