

M E R L Y N

6|series sleek

## SLIDING DOOR

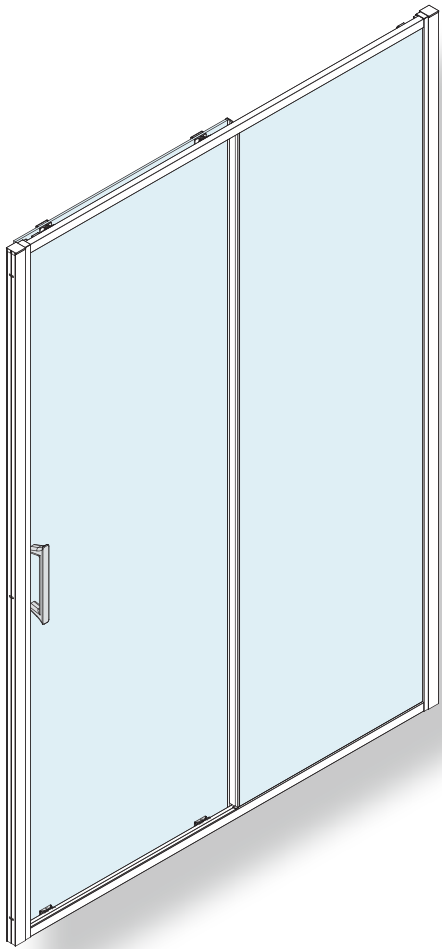

Pages 2-10

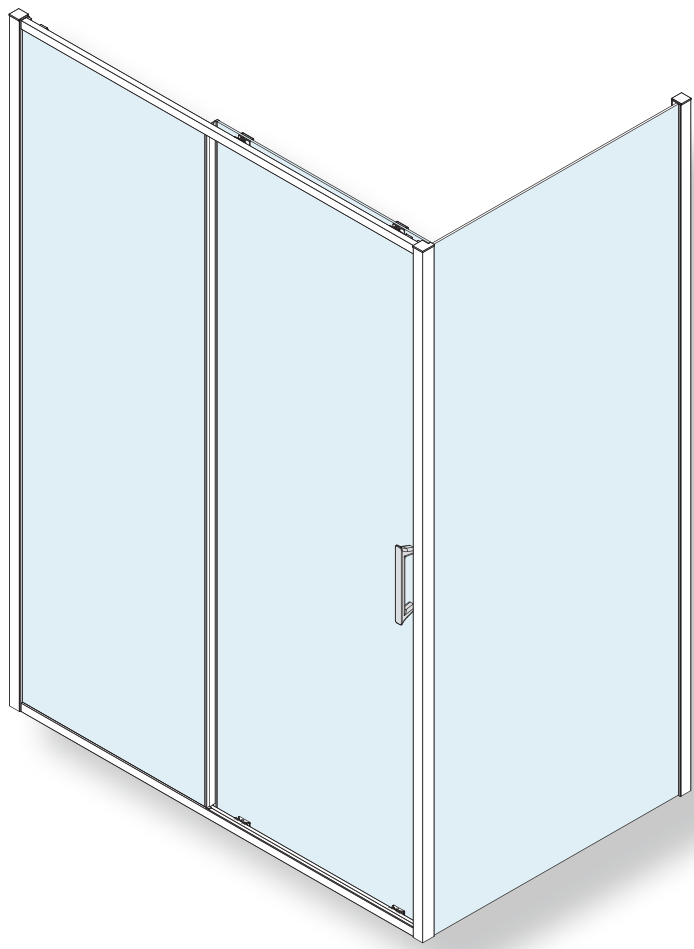

Pages 11-19

## INSTALLATION GUIDE

## **IMPORTANT:**

**Please read the complete instructions  
before commencing fitting.**

Make sure the tray is 100% level in all directions.  
Do Not attempt to install the product unless you  
can tick all 4 boxes satisfactorily.

- Check that you have the tools required ☐
- Check the installation site is compatible with  
the sizes of door supplied ☐
- Check all the enclosure components are present ☐
- Check the installation kit is complete ☐

The wall plugs supplied with the installation kit are  
for use in solid walls. Hollow or 'stud partition'  
walls will require alternative fixings. Please consult  
a hardware supplier for the correct type.  
It may also be necessary to consult your tiling  
supplier about the correct method for drilling  
your tiles.

**ATTENTION: TAKE EXTREME CARE WHEN  
HANDLING GLASS, WEAR PROTECTIVE EYEWEAR  
AND CLOTHING. DO NOT LEAVE THE GLASS ON  
HARD SURFACES AND AVOID CONTACT BETWEEN  
THE GLASS EDGES AND HARD SURFACES OR  
IMPACTS DURING THE INSTALLATION.**

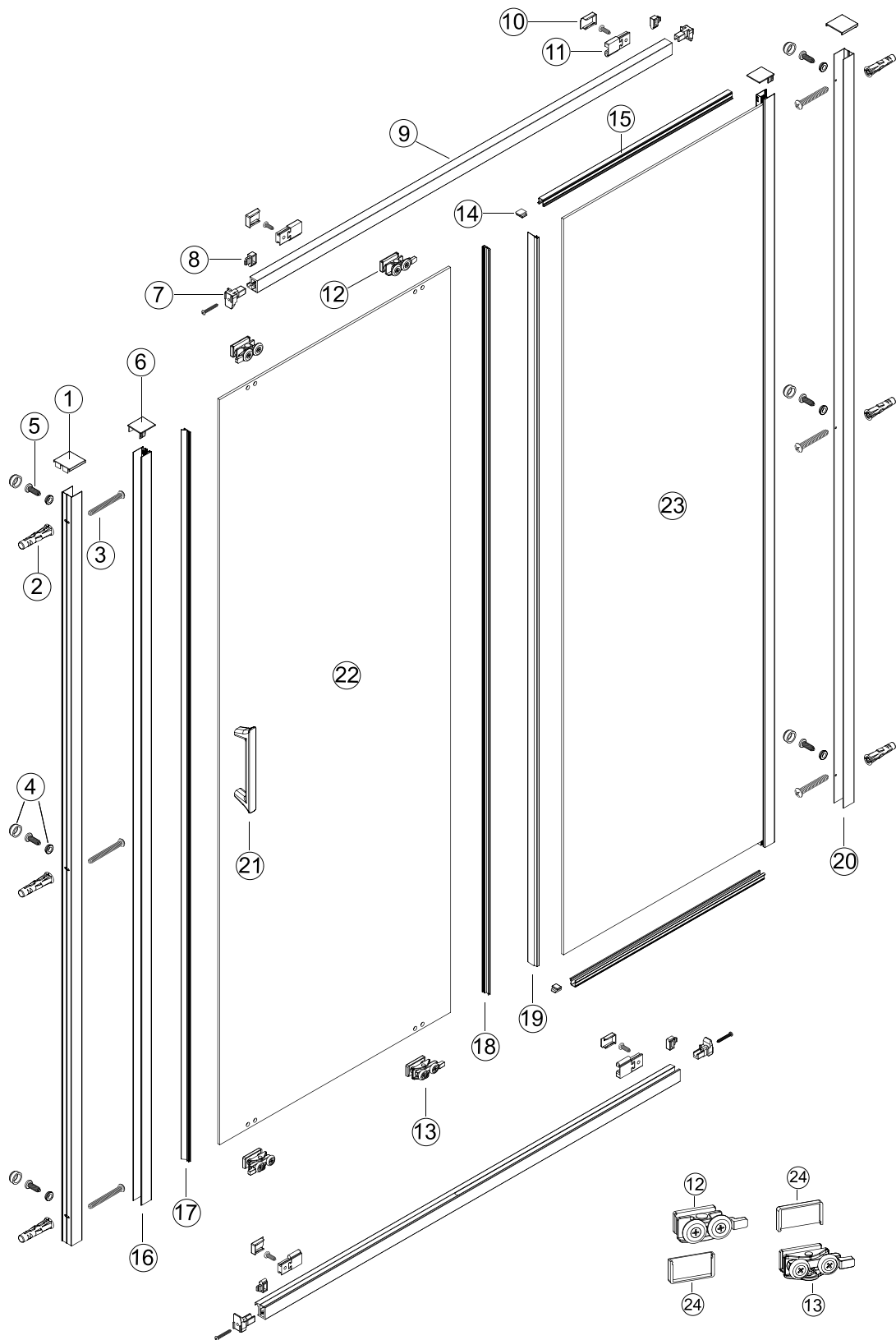

| No. | QTY | descriptions           | Part number | No. | QTY | descriptions        | Part number | No. | QTY | descriptions      | Part number |
|-----|-----|------------------------|-------------|-----|-----|---------------------|-------------|-----|-----|-------------------|-------------|
| ①   | 1   | Wall profile cover cap | SP0SS6026   | ⑨   | 1   | Top/Bottom rail     | A           | ⑰   | 1   | Closing seal      | SP0SS6018   |
| ②   | 6   | Wall plug              | A03S0090    | ⑩   | 4   | Stop cover cap      | SP0SS6036   | ⑱   | 1   | Moving panel seal | SP0SS6015   |
| ③   | 6   | 4x30 screw             | A03S0089    | ⑪   | 2   | Cushioned stop      | SP0SS6048   | ⑲   | 1   | Fixed panel seal  | SP0SS6013   |
| ④   | 6   | Screw cover cap & clip | SP0SS6028   | ⑫   | 1   | Top roller set      | SP0SS6021   | ⑳   | 2   | Wall profile      | SP0SS6001   |
| ⑤   | 6   | 4x10 screw             | SP0V4110    | ⑬   | 1   | Bottom roller set   | SP0SS6022   | ㉑   | 1   | Handle            | SP0SS6029   |
| ⑥   | 2   | Frame cover cap        | SP0SS6027   | ⑭   | 2   | Fixed panel clip    | SP0SS6031   | ㉒   | 1   | Moving panel      | B           |
| ⑦   | 4   | Connecting block       | SP0SS6032   | ⑮   | 2   | Straight fixed seal | SP0SS6040   | ㉓   | 1   | Fixed panel       | C           |
| ⑧   | 4   | Locking clip           | SP0SS6033   | ⑯   | 1   | Closing post        | SP0SS6002   | ㉔   | 4   | Roller cover cap  | SP0SS6023   |

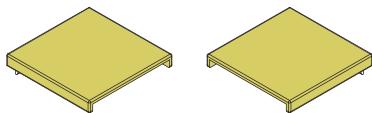
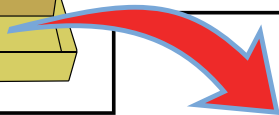
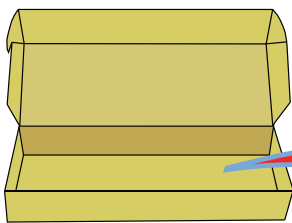

SP0SS6026  
X1

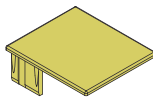

SP0SS6027  
X2



SP0V4110 X6    SP0SS6028  
X6

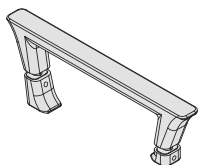

SP0SS6029  
X1

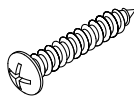

A03S0089  
X6

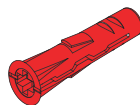

A03S0090  
X6



SP08S1300511  
X1

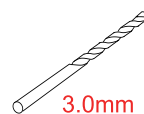

SP08S1301152  
X1

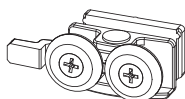

SP0SS6021  
X1

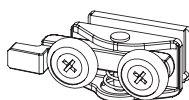
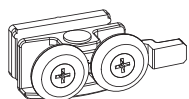

SP0SS6022  
X1

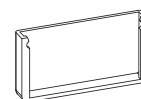
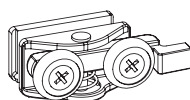

SP0SS6023  
X4

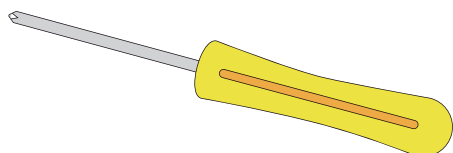
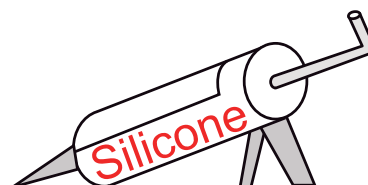
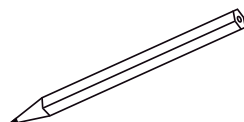
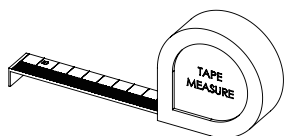
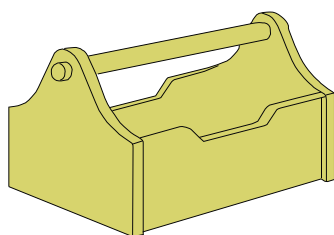

PH2

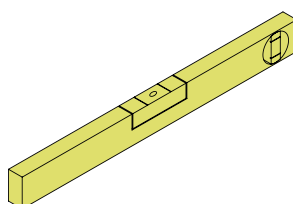

Ø6





1

Ensure the shower tray is level in all directions and is properly sealed to the wall. The wall must be tiled down to the top edge of the tray.

Do not angle out bottom tile.  
TRAY MUST BE LEVEL IN ALL DIRECTIONS!

TRAY MUST BE SEALED FULLY AROUND WHERE THE TRAY MEETS THE WALL.

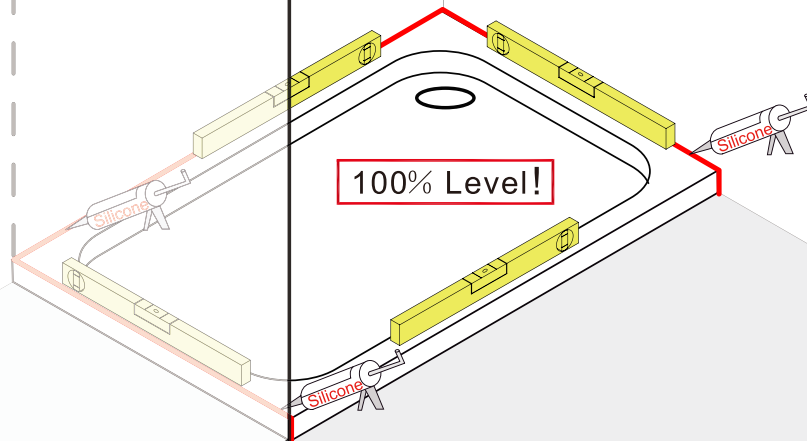
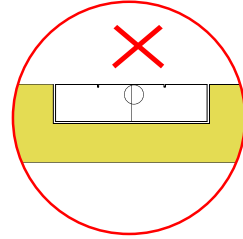
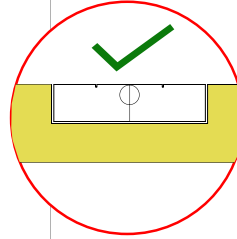

2

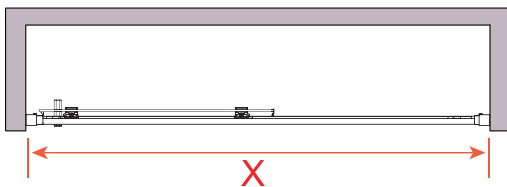

| Size | X         | Size | X         |
|------|-----------|------|-----------|
| 1000 | 950-990   | 1500 | 1450-1490 |
| 1100 | 1050-1090 | 1600 | 1550-1590 |
| 1200 | 1150-1190 | 1700 | 1650-1690 |
| 1400 | 1350-1390 |      |           |

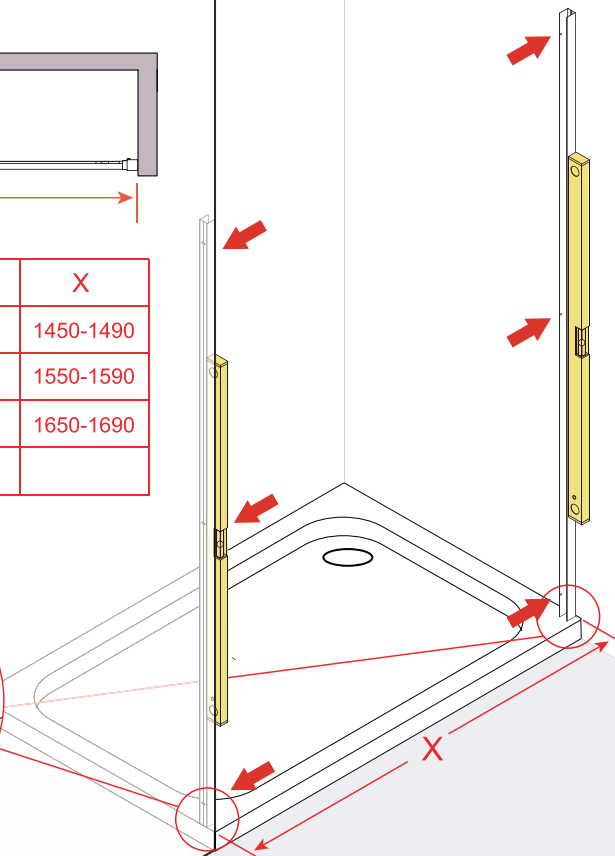
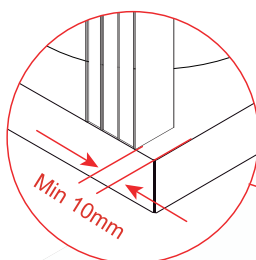

2A

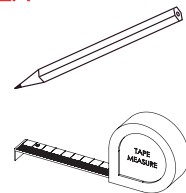

2B

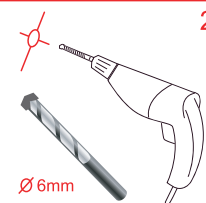

2C



3

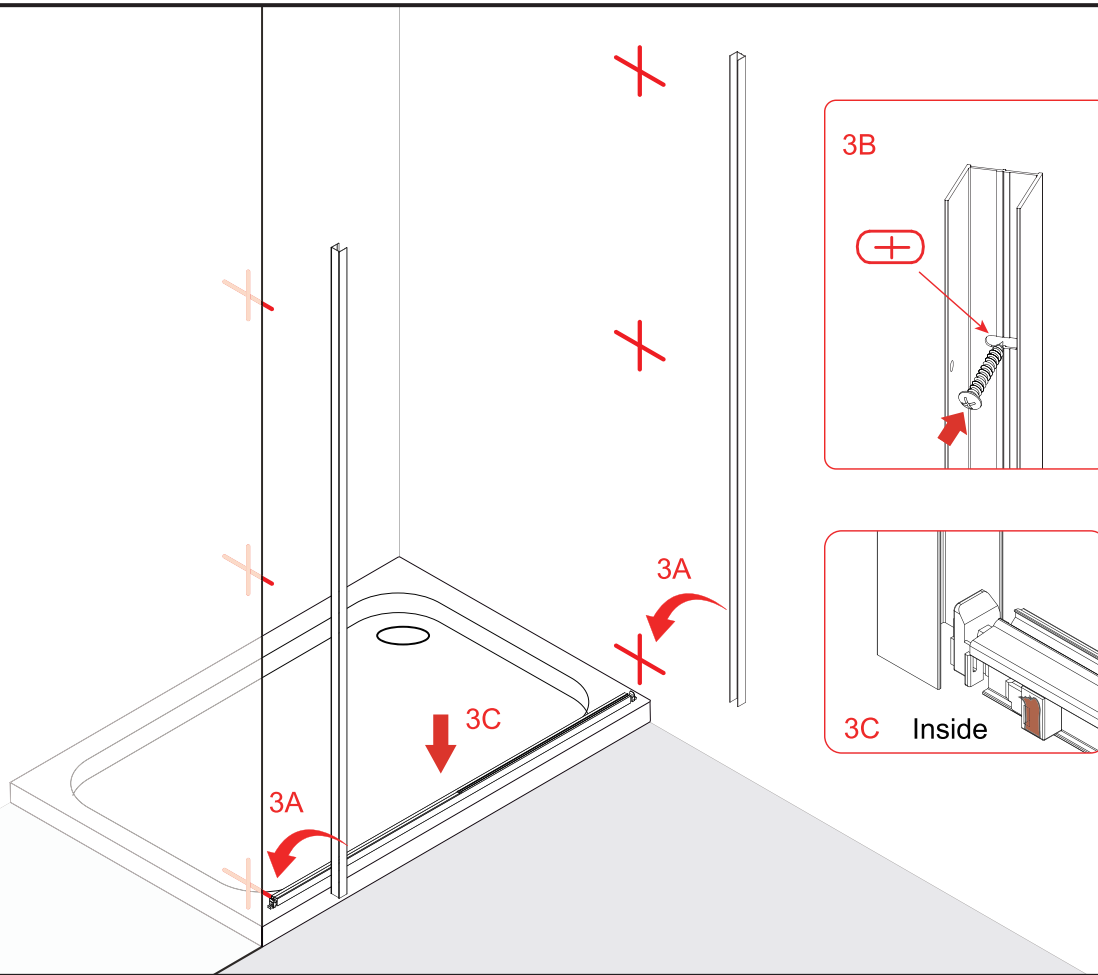

4

**4A.** Slide the fixed panel into the wall profile just above the bottom profile.  
**4B.** Slowly lower the panel while guiding the inner edge of the fixed panel profile with the end of the bottom profile.

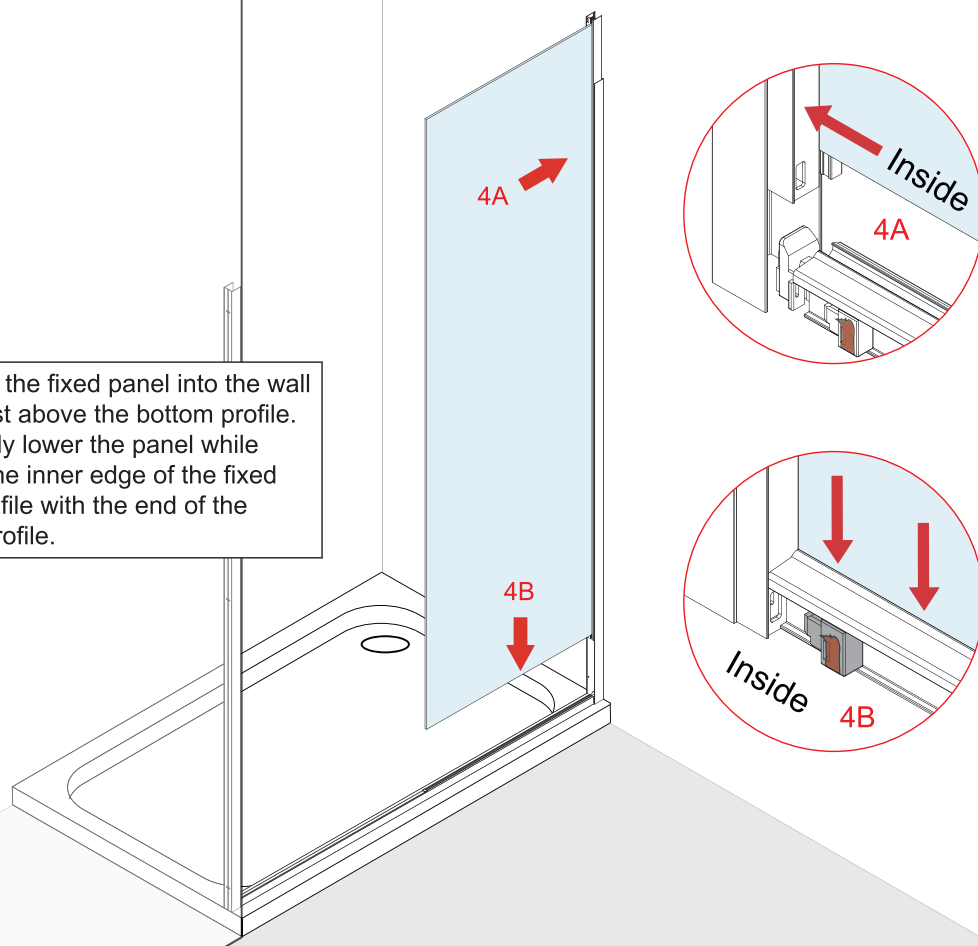

5

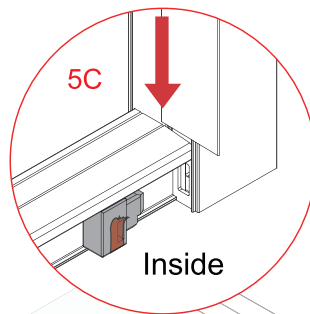
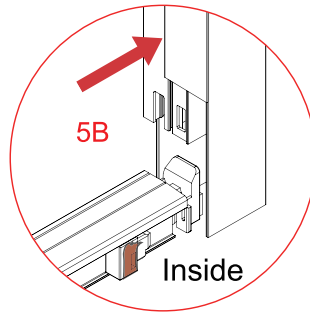
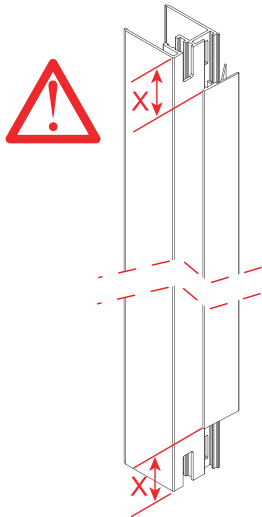
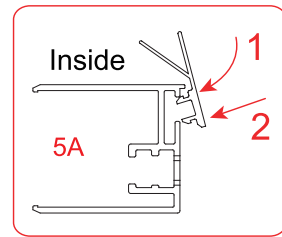

5B

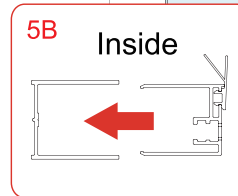

5C

5A. Push the closing seal into closing post.

5B. Slide the closing post into the wall profile.

5C. Slowly lower the post while guiding the inner edge of the post with the end of the bottom profile.

6

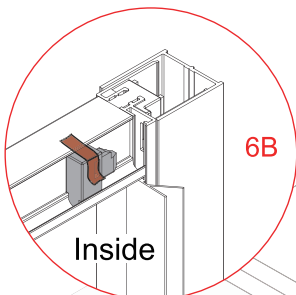
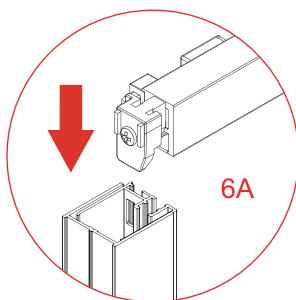

6A

6A

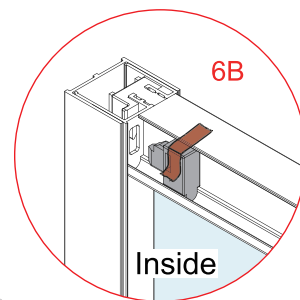
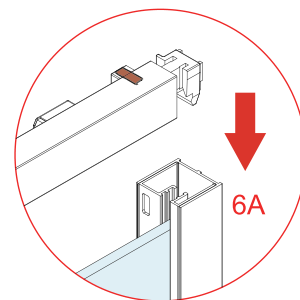

7

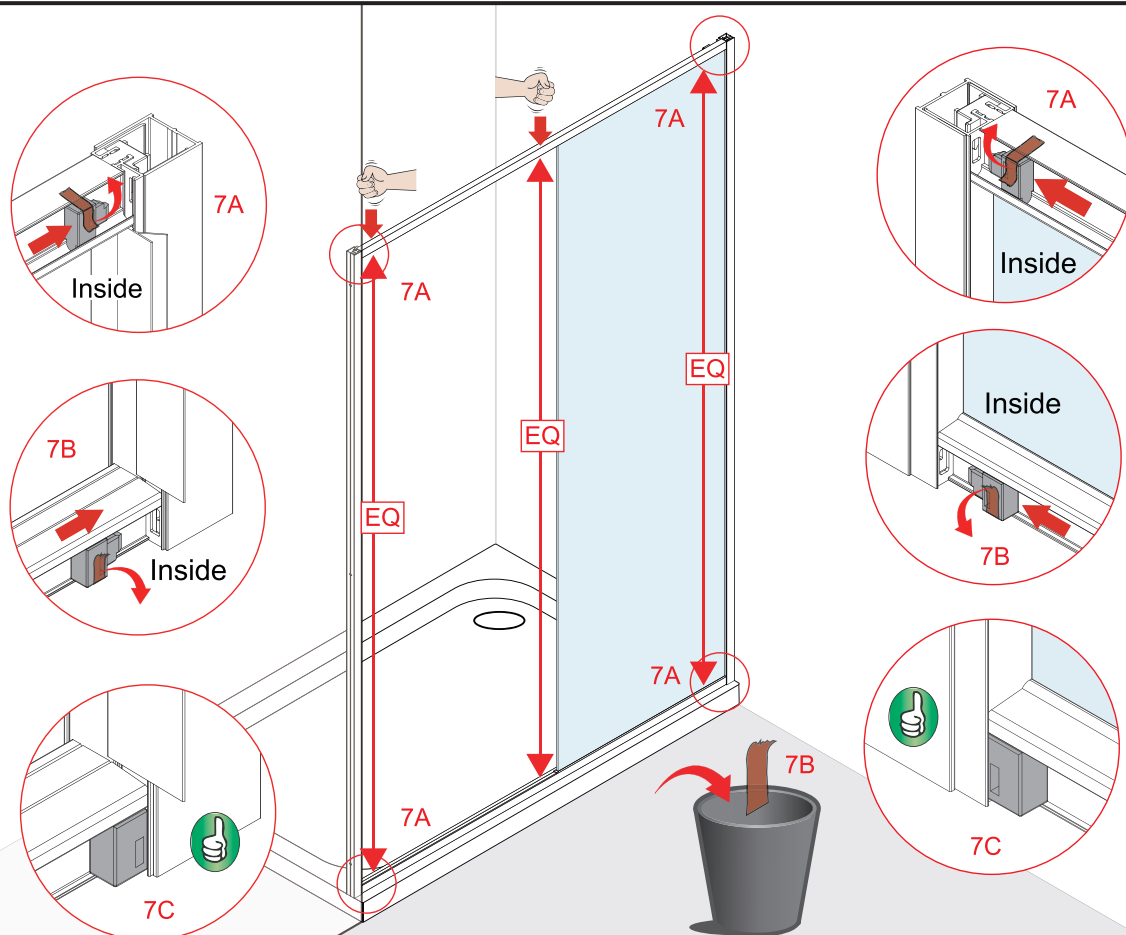

8

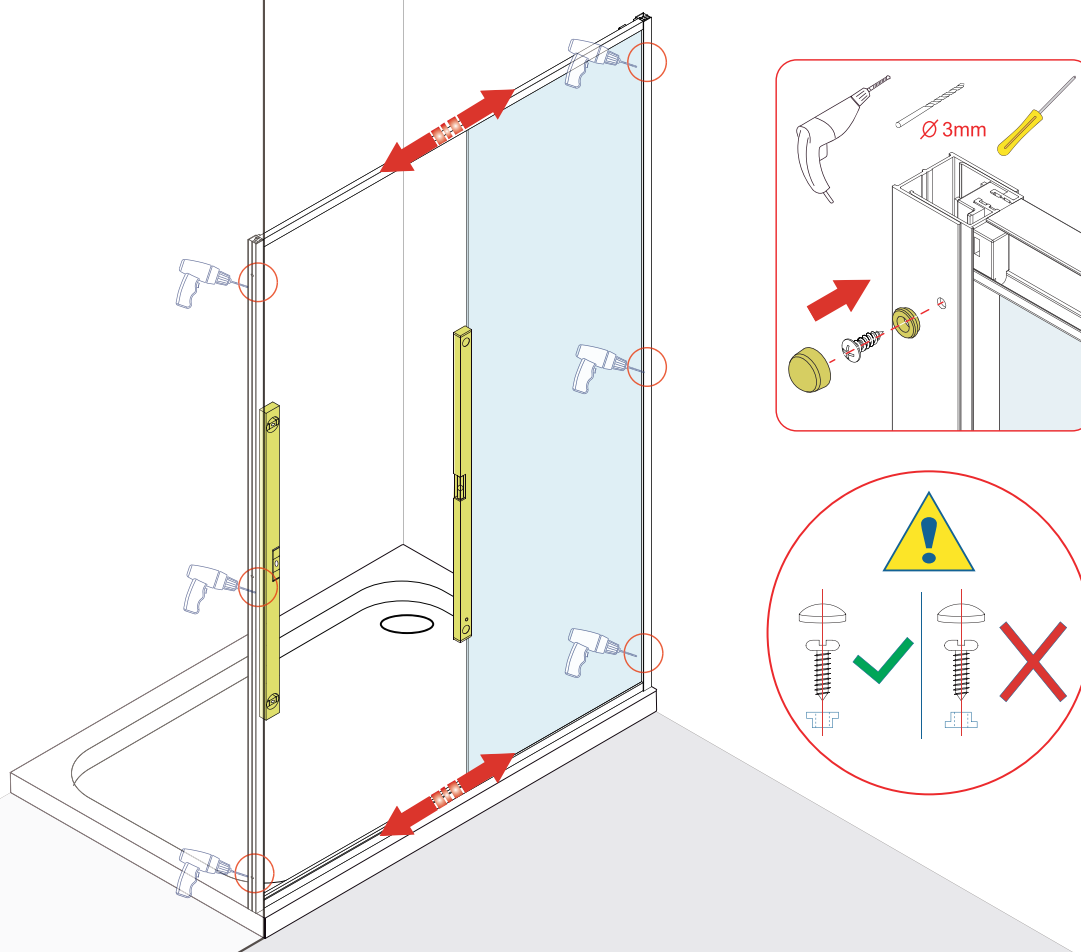

9

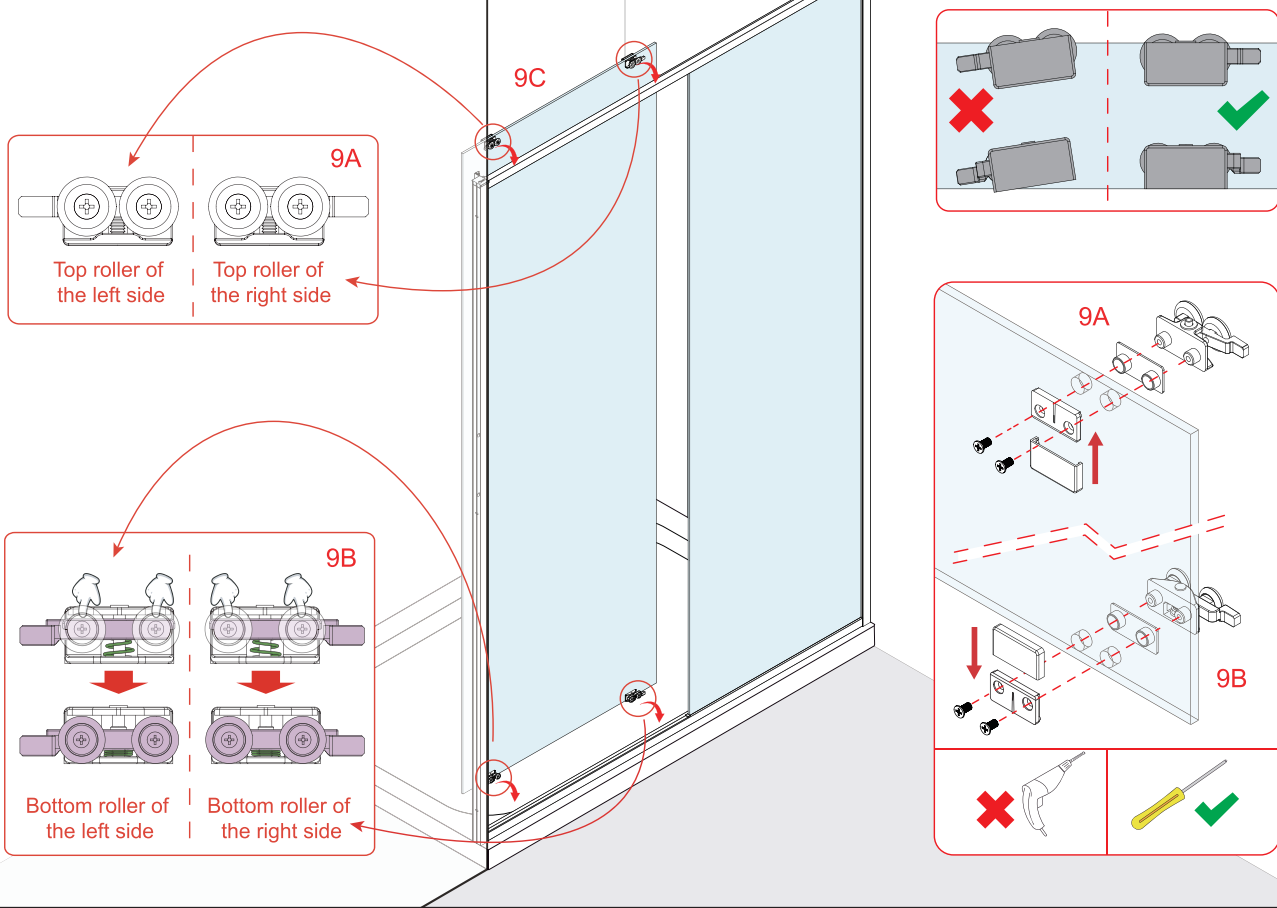

10

**10B**

1. Apply a bead of silicone to the edge and outside of the fixed panel where it meets the bottom profile.

2. Slide the clip tight to the edge of the glass.

3. Fit the end of the notched seal to the bottom first ensuring no gap between the top of the clip and the seal.

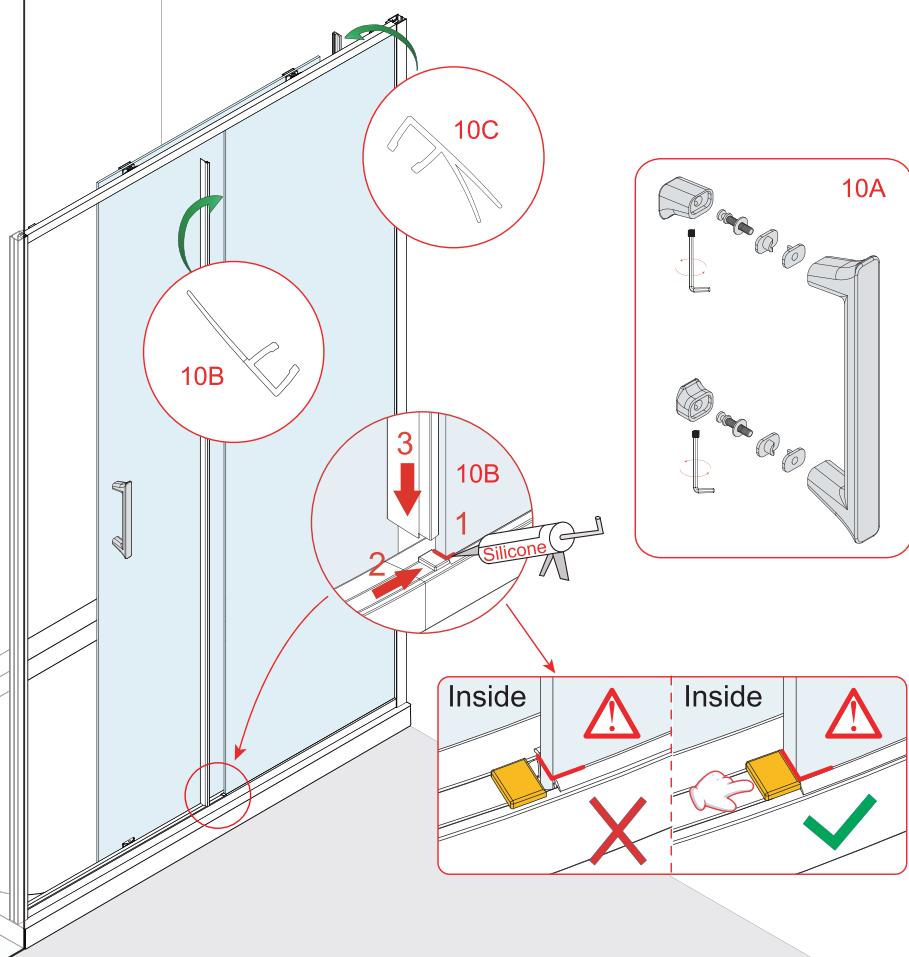

11

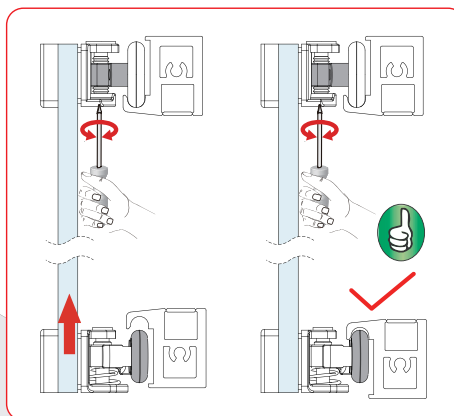
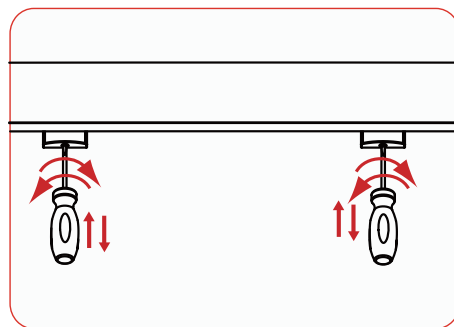
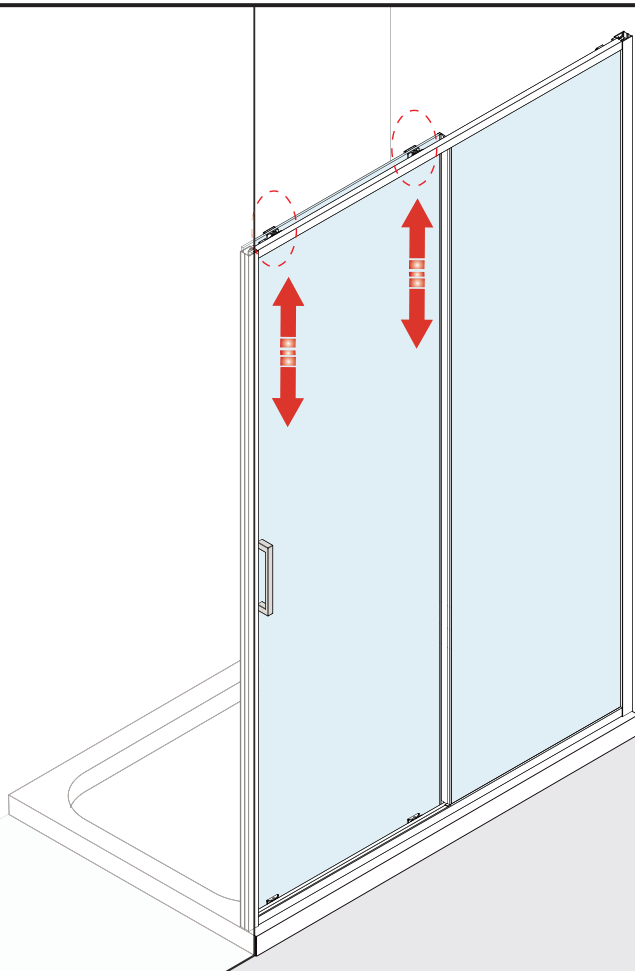

12

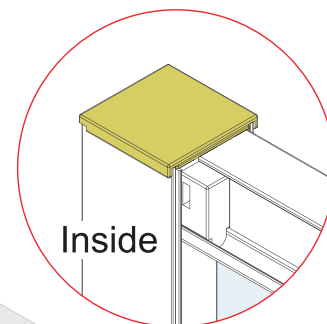
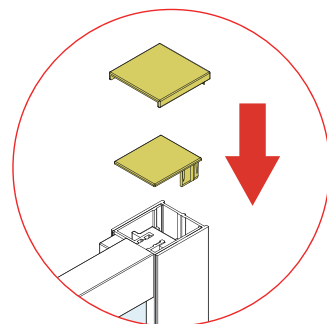
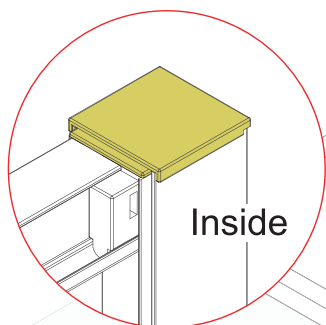
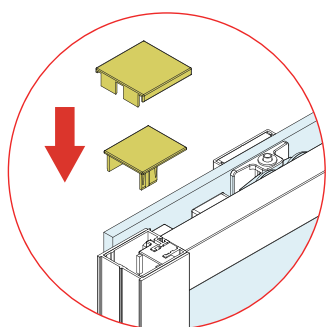
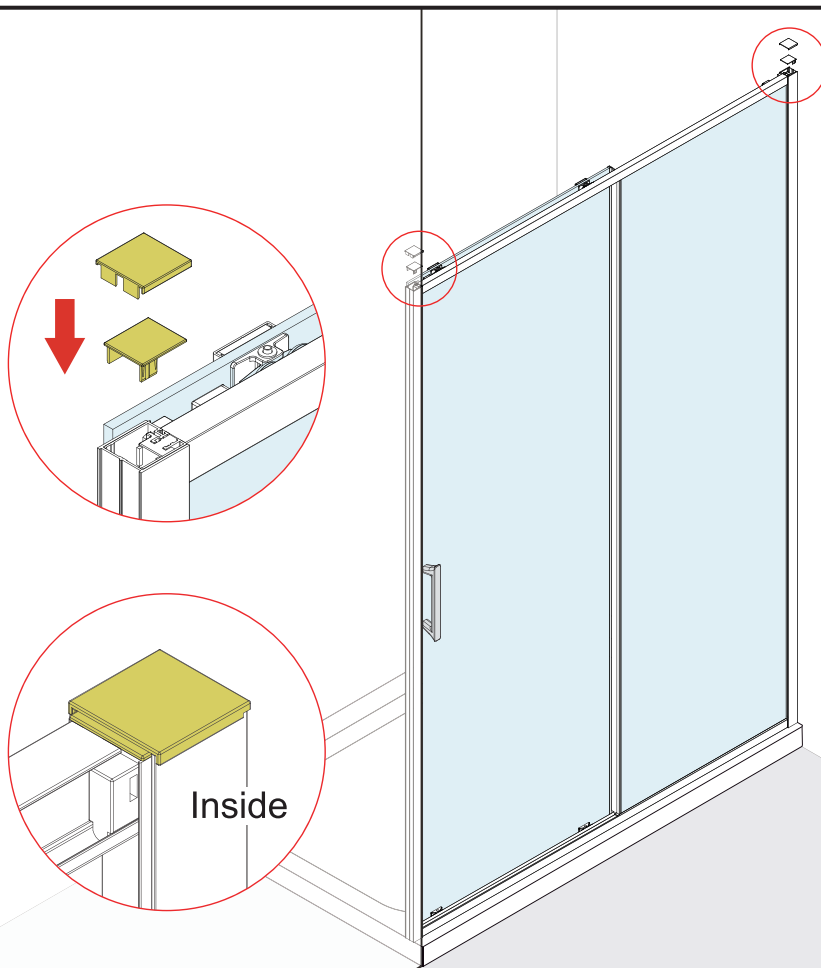

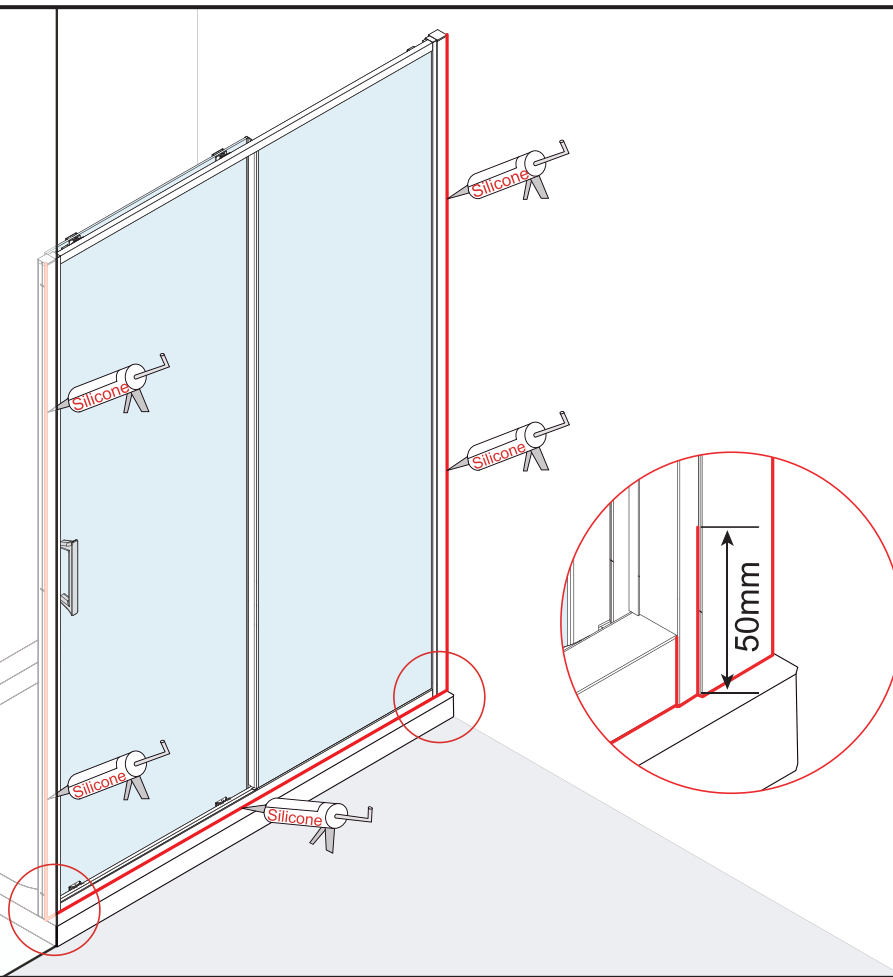
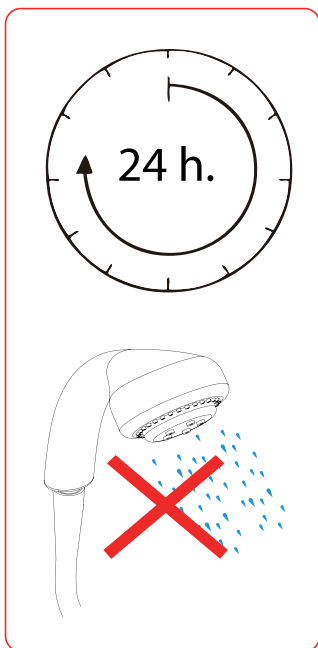

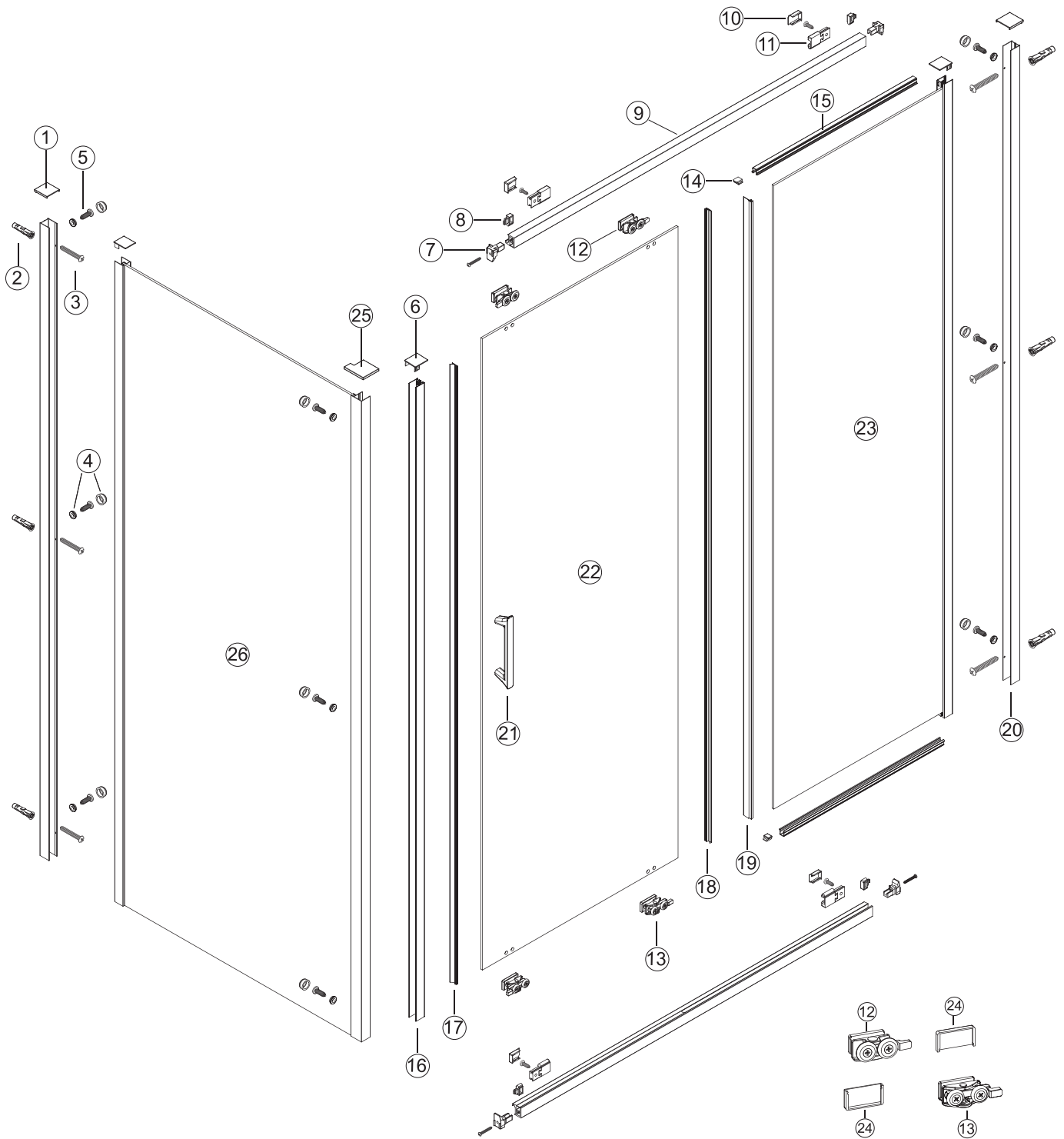

| No. | QTY | descriptions           | Part number | No. | QTY | descriptions        | Part number | No. | QTY | descriptions          | Part number |
|-----|-----|------------------------|-------------|-----|-----|---------------------|-------------|-----|-----|-----------------------|-------------|
| ①   | 1   | Wall profile cover cap | SP0SS6026   | ⑩   | 4   | Stop cover cap      | SP0SS6036   | ⑲   | 1   | Fixed panel seal      | SP0SS6013   |
| ②   | 6   | Wall plug              | A03S0090    | ⑪   | 2   | Cushioned stop      | SP0SS6048   | ⑳   | 2   | Wall profile          | SP0SS6001   |
| ③   | 6   | 4x30 screw             | A03S0089    | ⑫   | 1   | Top roller set      | SP0SS6021   | ㉑   | 1   | Handle                | SP0SS6029   |
| ④   | 9   | Screw cover cap & clip | SP0SS6028   | ⑬   | 1   | Bottom roller set   | SP0SS6022   | ㉒   | 1   | Moving panel          | B           |
| ⑤   | 9   | 4x10 screw             | SP0V4110    | ⑭   | 2   | Fixed panel clip    | SP0SS6031   | ㉓   | 1   | Fixed panel           | C           |
| ⑥   | 2   | Frame cover cap        | SP0SS6027   | ⑮   | 2   | Straight fixed seal | SP0SS6040   | ㉔   | 4   | Roller cover cap      | SP0SS6023   |
| ⑦   | 4   | Connecting block       | SP0SS6032   | ⑯   | 1   | Closing post        | SP0SS6002   | ㉕   | 1   | Corner post cover cap | SP0SS6030   |
| ⑧   | 2   | Locking clip           | SP0SS6033   | ⑰   | 1   | Closing seal        | SP0SS6018   | ㉖   | 1   | Side Panel            | D           |
| ⑨   | 2   | Top/Bottom rail        | A           | ⑱   | 1   | Moving panel seal   | SP0SS6015   |     |     |                       |             |



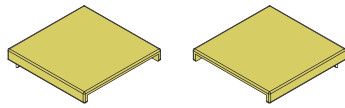
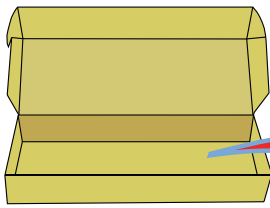

SP0SS6026  
X1

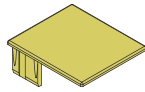

SP0SS6027  
X3



SP0V4110 SP0SS6028  
X9 X9

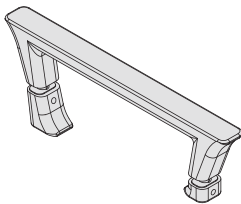

SP0SS6029  
X1

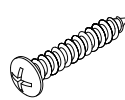

A03S0089  
X6

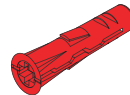

A03S0090  
X6

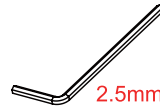

SP08S1300511  
X1

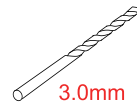

SP08S1301152  
X1

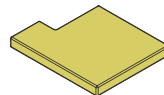

SP0SS6030  
X1

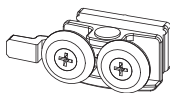
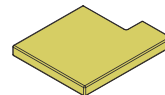

SP0SS6021  
X1

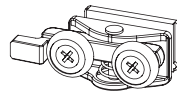
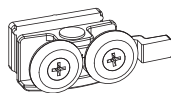

SP0SS6022  
X1

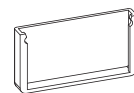
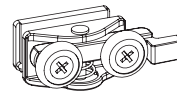

SP0SS6023  
X4

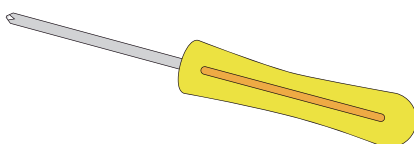
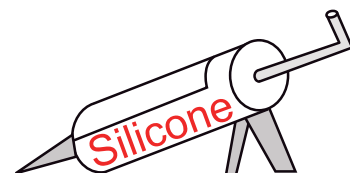
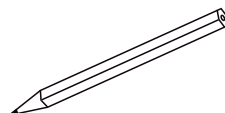
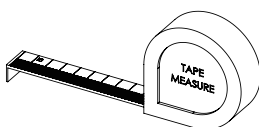
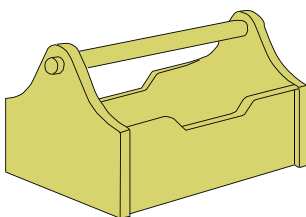

PH2

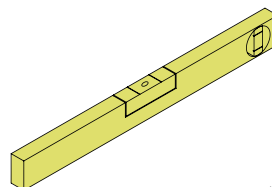

Ø6



1

Ensure the shower tray is level in all directions and is properly sealed to the wall. The wall must be tiled down to the top edge of the tray.

Do not angle out bottom tile.

**TRAY MUST BE LEVEL IN ALL DIRECTIONS!**

**TRAY MUST BE SEALED FULLY AROUND WHERE THE TRAY MEETS THE WALL.**

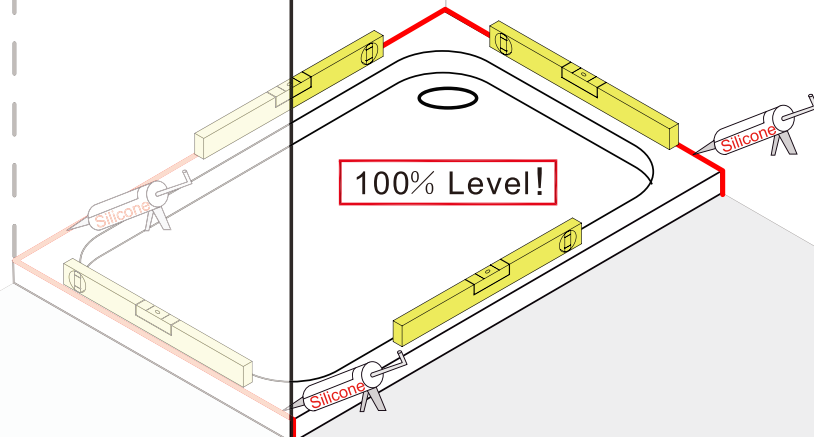
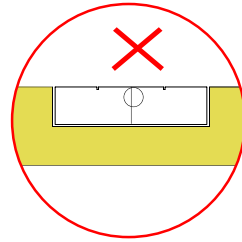
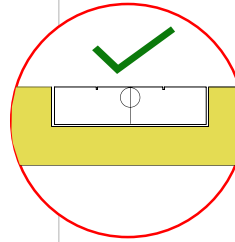

2

**NOTE:** Shown here with door fitted on right hand side. In this case X represents the adjustment range for the side panel profile. Y is the adjustment range for the door profile. If fitting the door on the left side then swap these around.

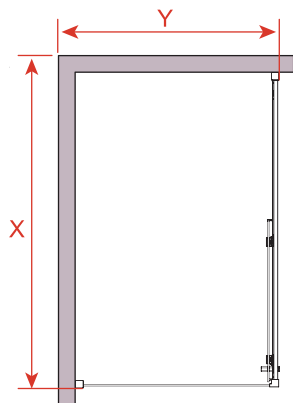

| Size | X<br>Side panel | Y<br>Door |
|------|-----------------|-----------|
| 760  |                 | 730-750   |
| 800  |                 | 770-790   |
| 900  |                 | 870-890   |
| 1000 |                 | 970-990   |
| 1200 |                 | 1170-1190 |
| 1000 | 953-993         |           |
| 1100 | 1053-1093       |           |
| 1200 | 1153-1193       |           |
| 1400 | 1353-1393       |           |
| 1500 | 1453-1493       |           |
| 1600 | 1553-1593       |           |
| 1700 | 1653-1693       |           |

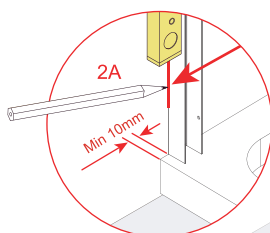

2A

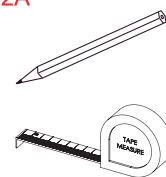

2B

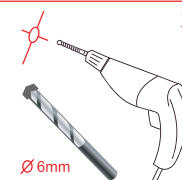

2C



3

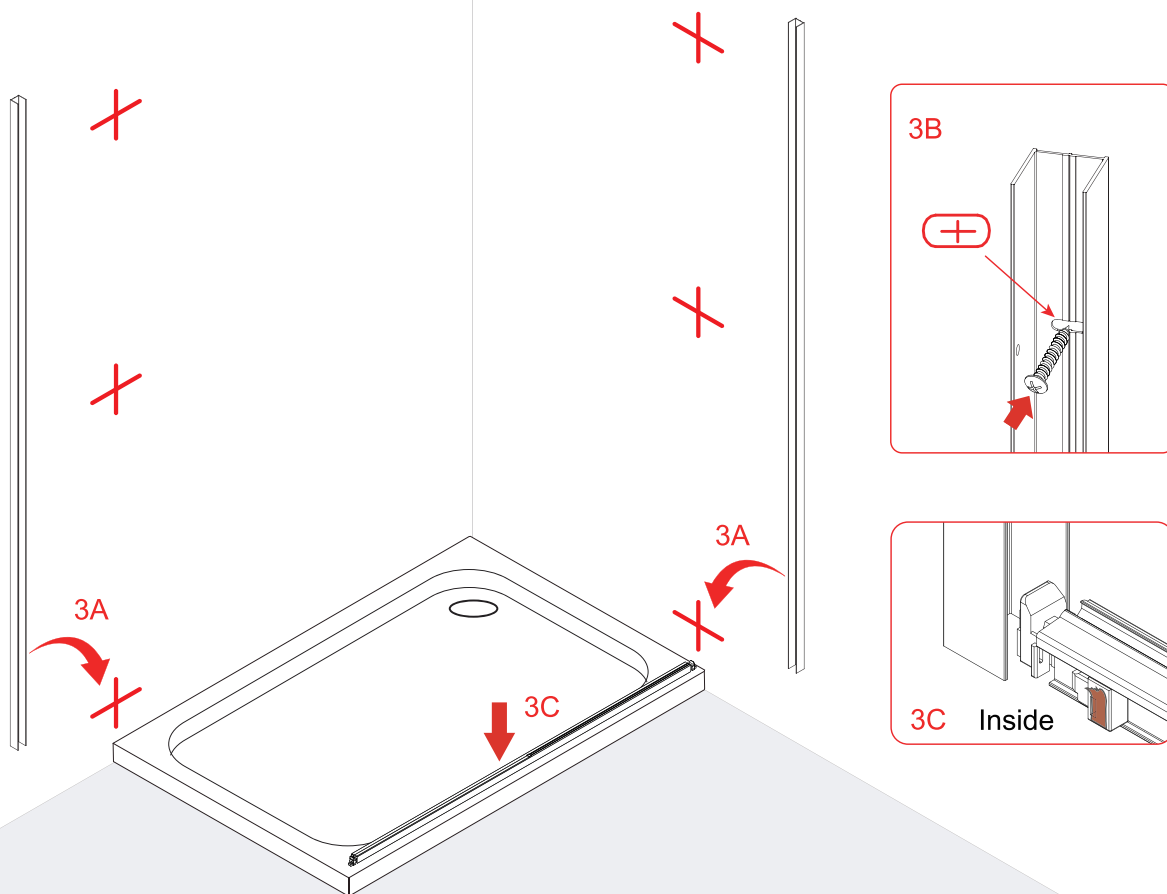

4

**4A.** Slide the fixed panel into the wall profile just above the bottom profile.  
**4B.** Slowly lower the panel while guiding the inner edge of the fixed panel profile with the end of the bottom profile.

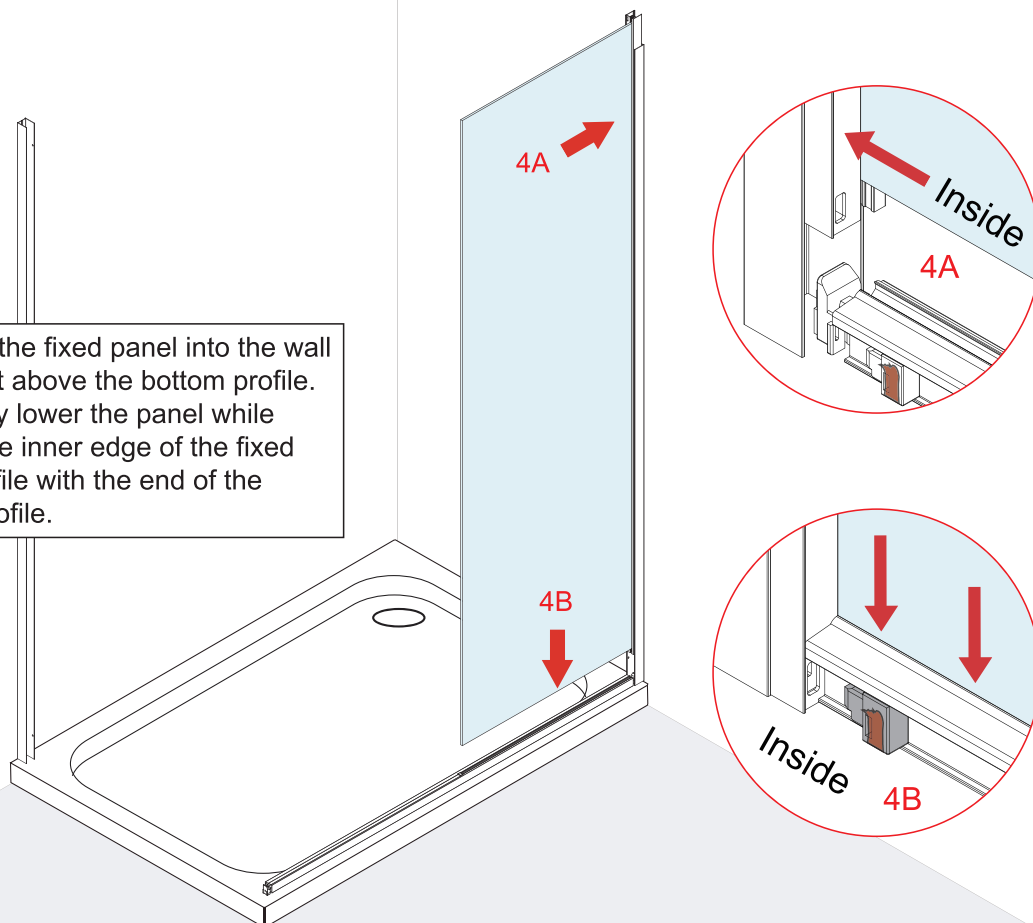

5

**5A.** Push the closing seal into the closing post.

**5B.** Position the closing post above the bottom profile, keeping the seal to the inside.

**5C.** Slide the closing post down over the end of the bottom profile.

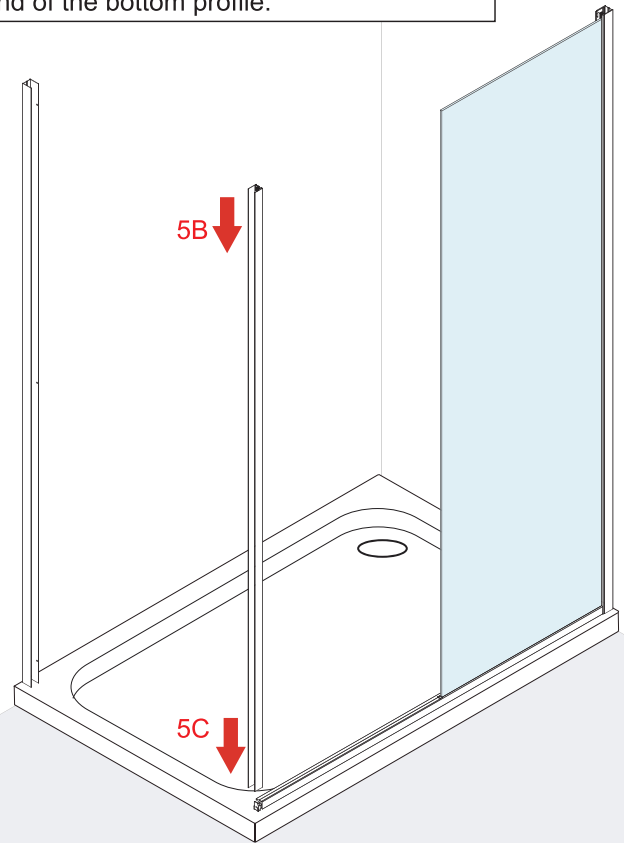
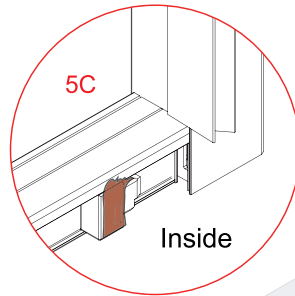
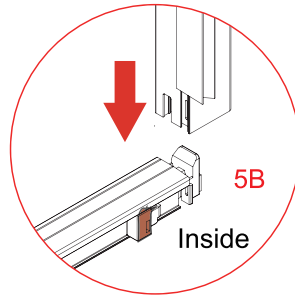
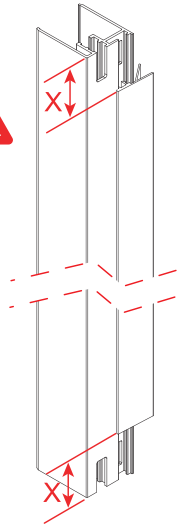
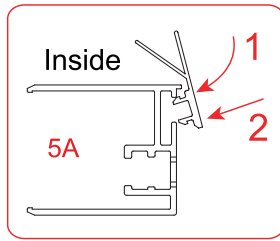

6

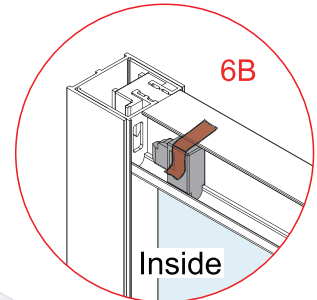
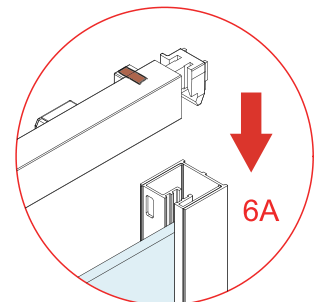
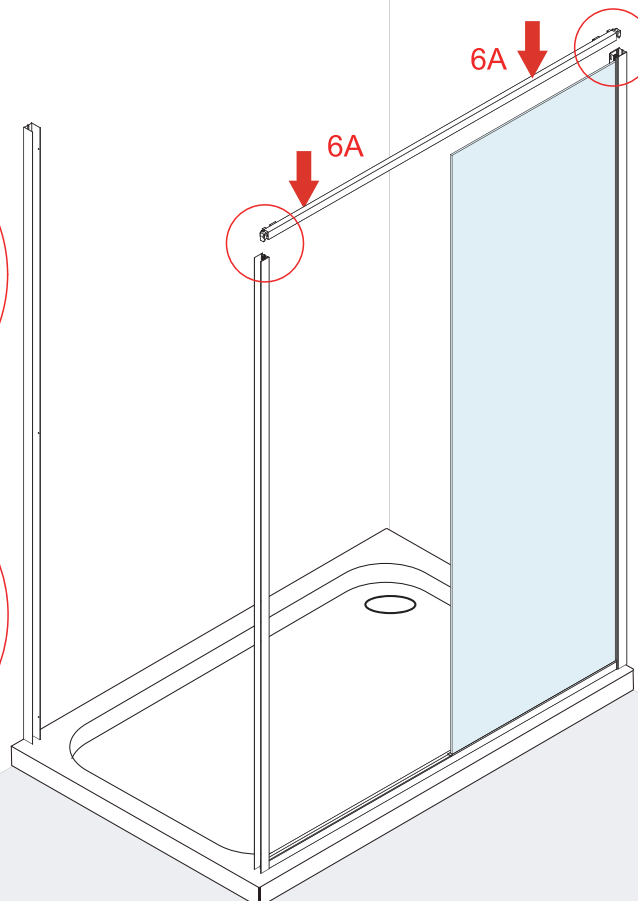
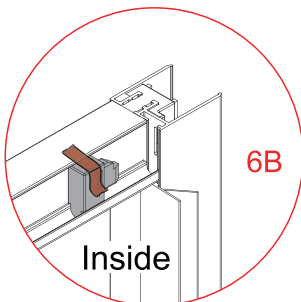
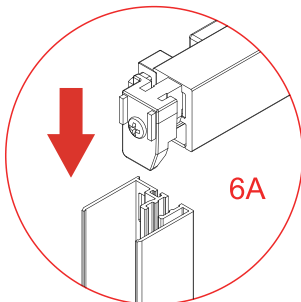

7

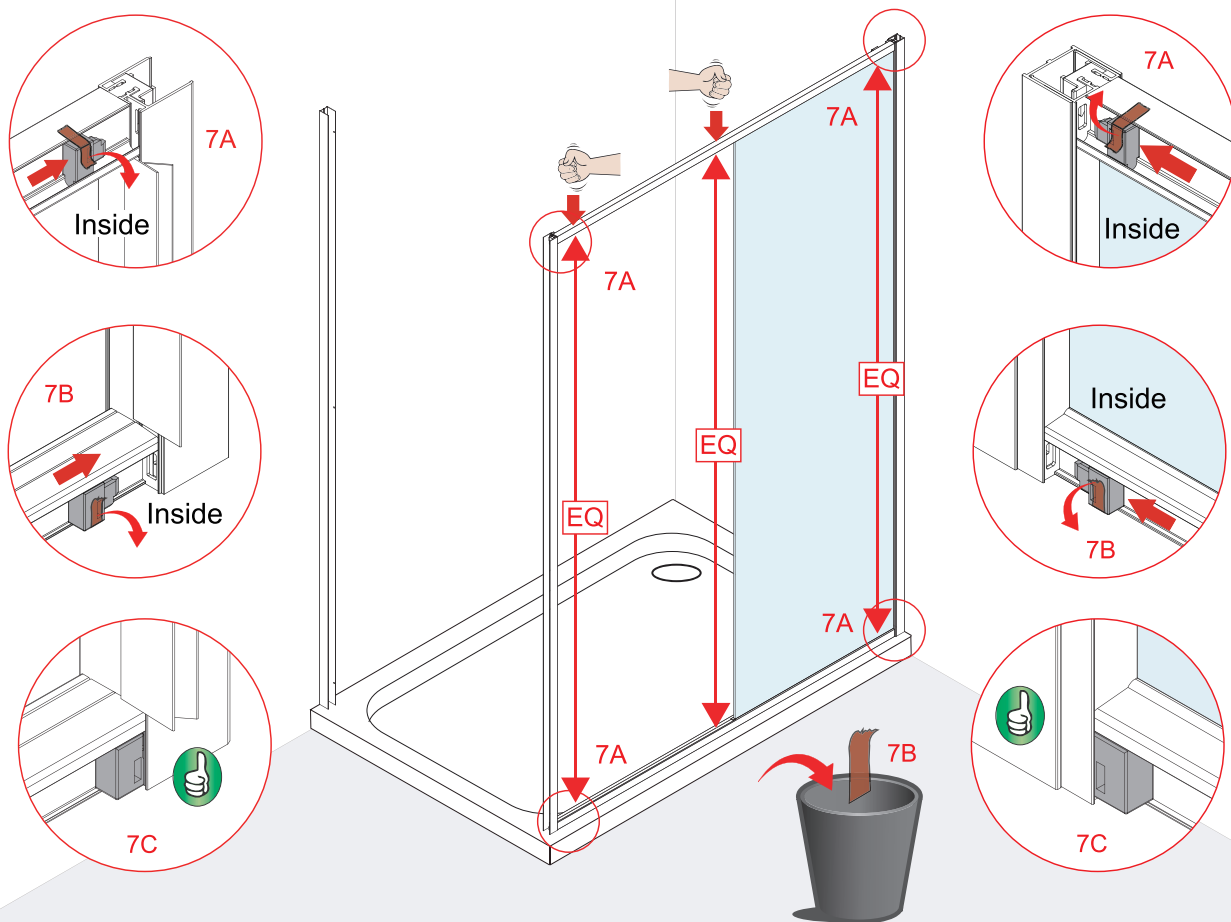

8

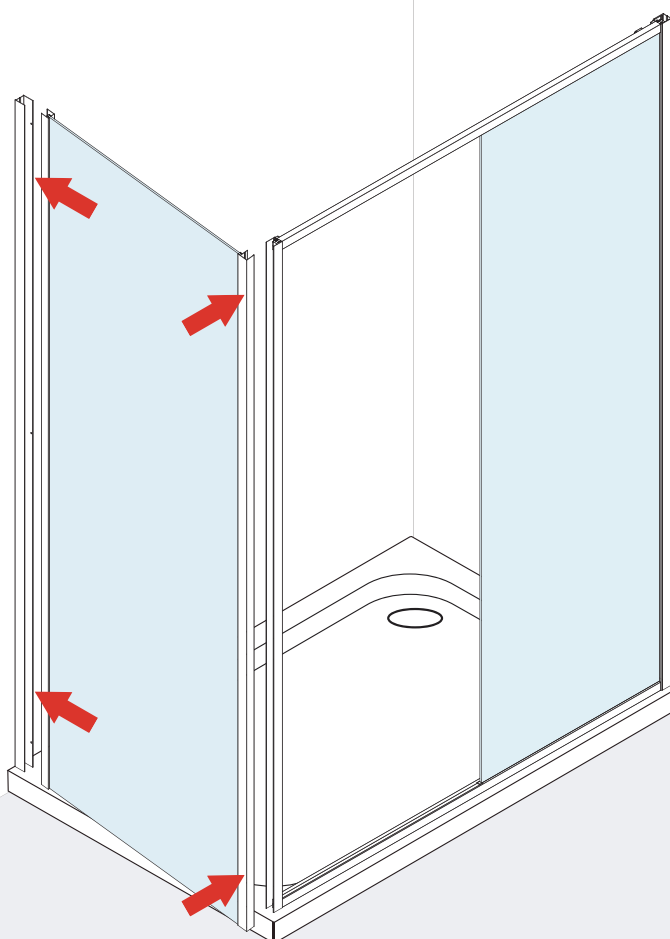

9

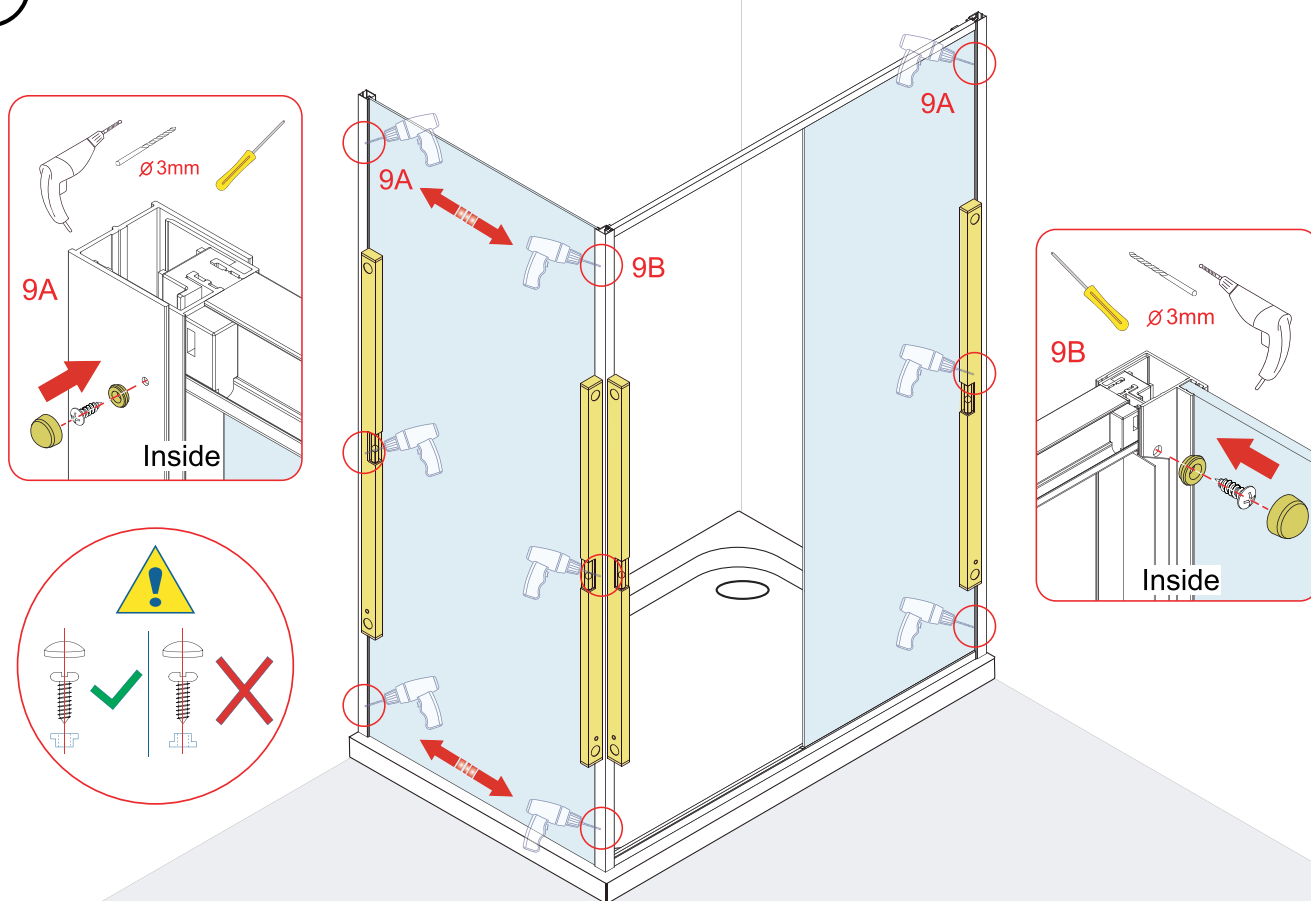

10

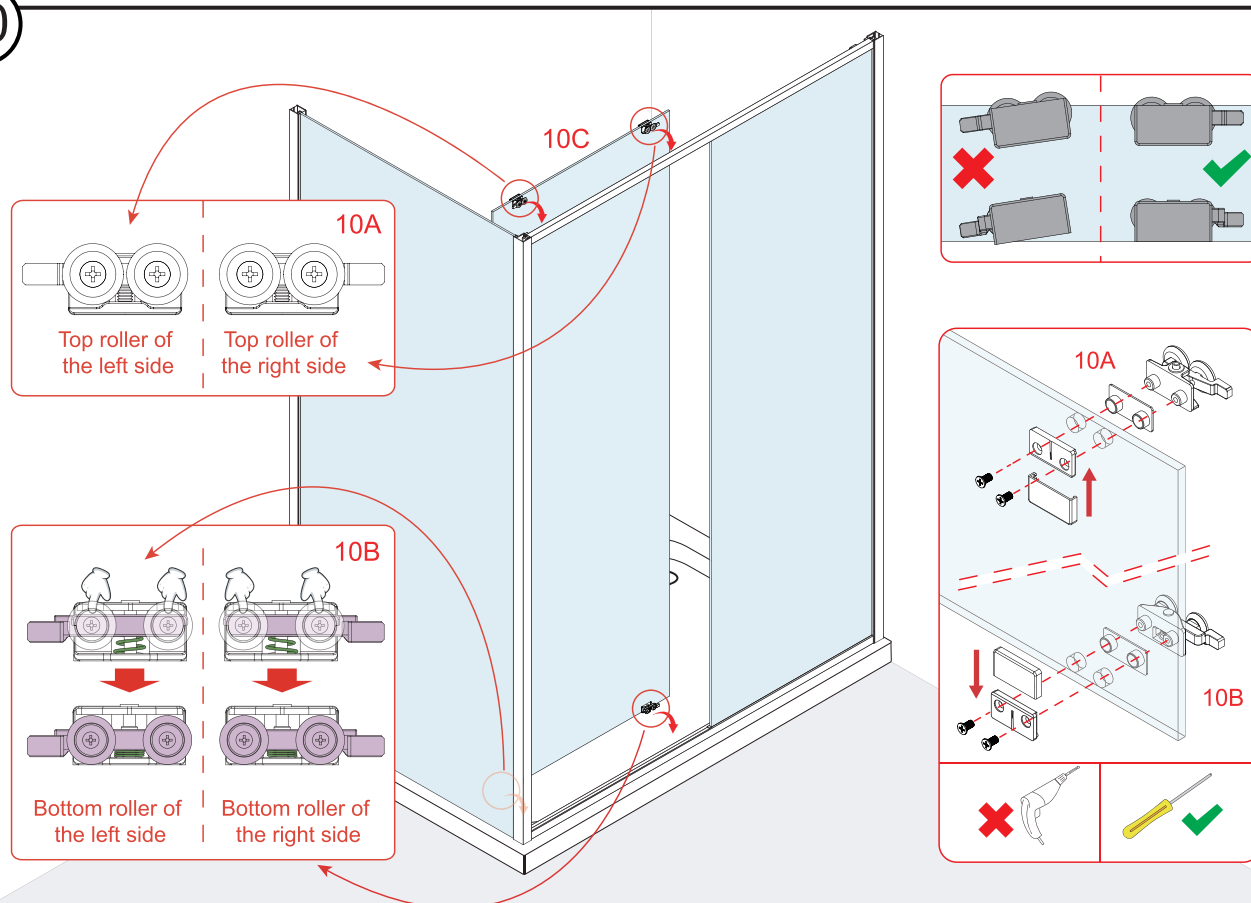

11

### 11B

1. Apply a bead of silicone to the edge and outside of the fixed panel where it meets the bottom profile.

2. Slide the clip tight to the edge of the glass.

3. Fit the end of the notched seal to the bottom first ensuring no gap between the top of the clip and the seal.

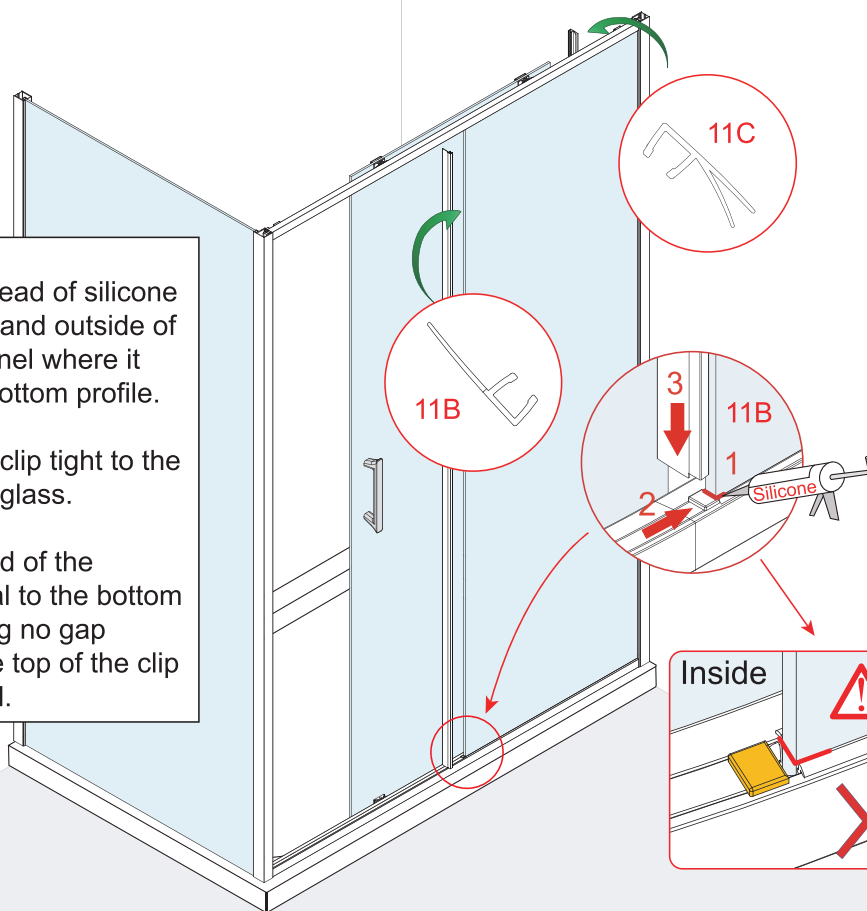

11C

11B

3

11B

Silicone

11A

Inside

Inside

12

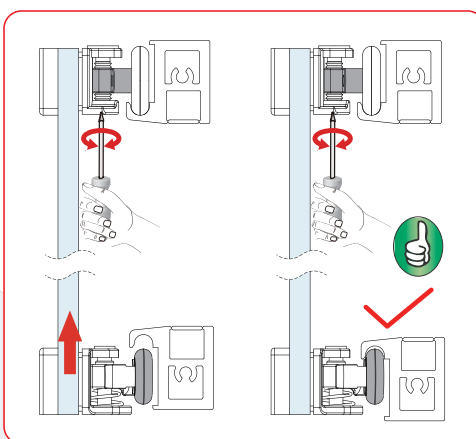
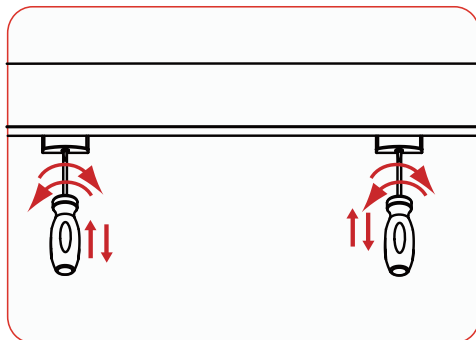
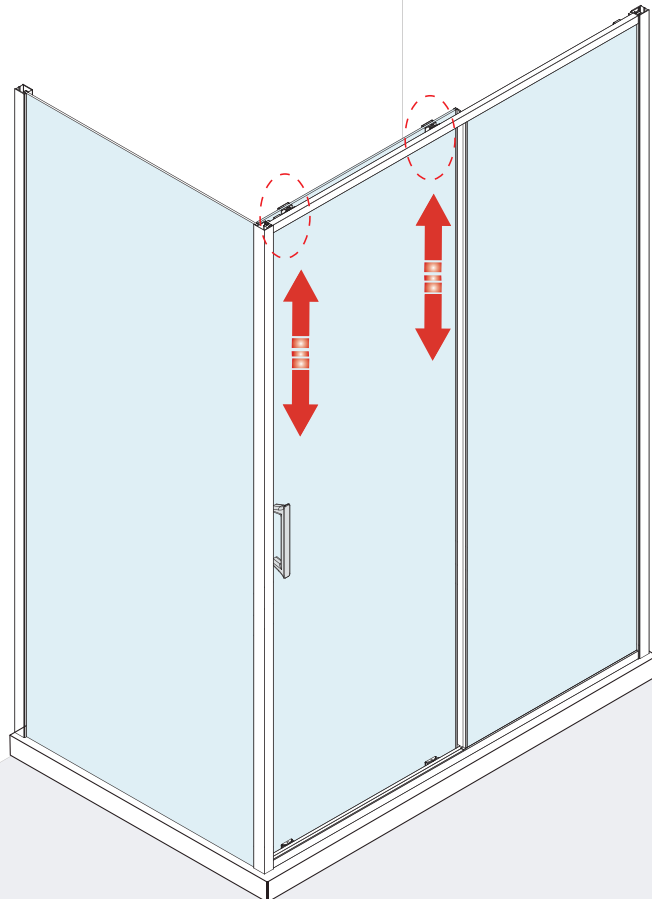

13

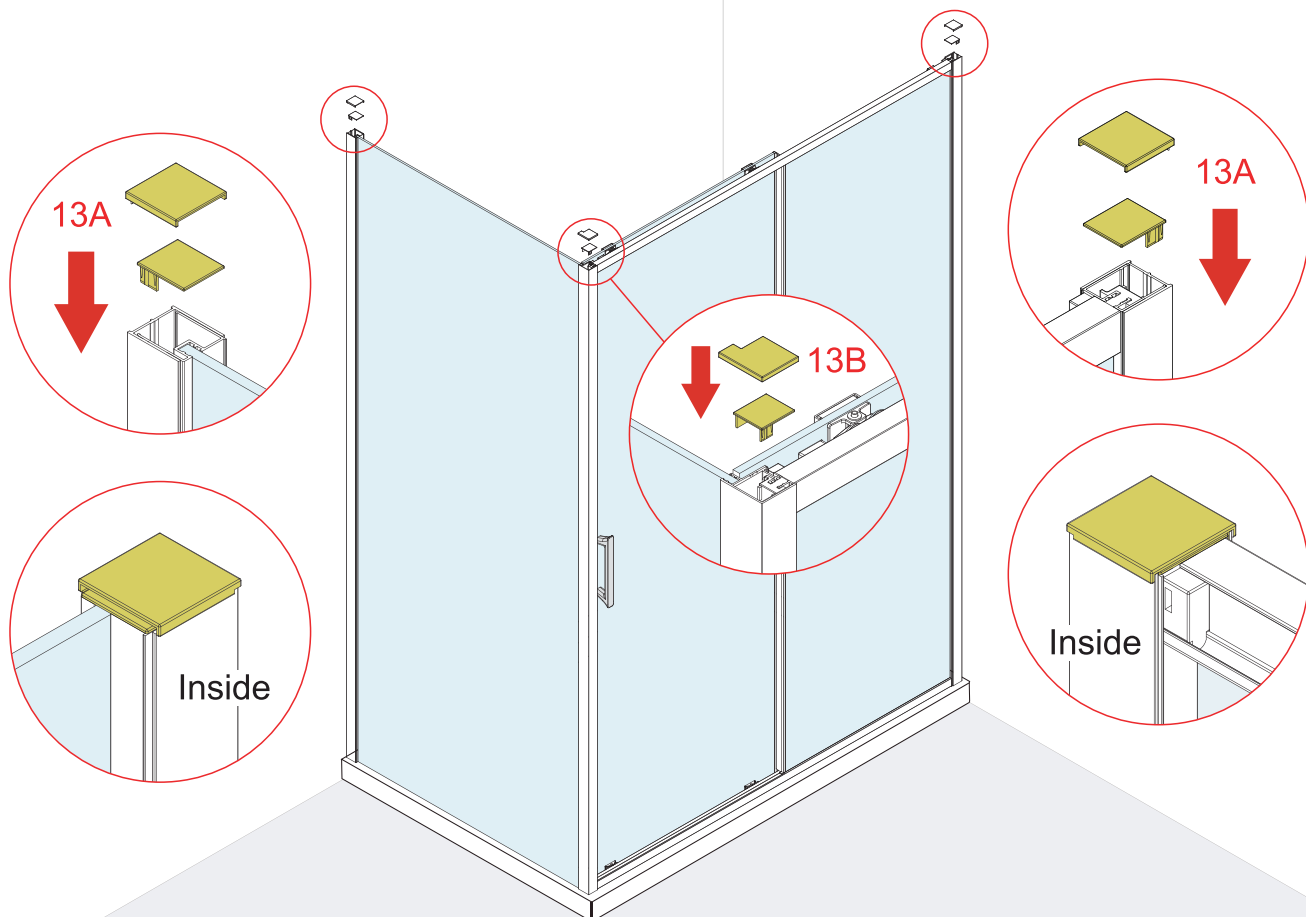

14

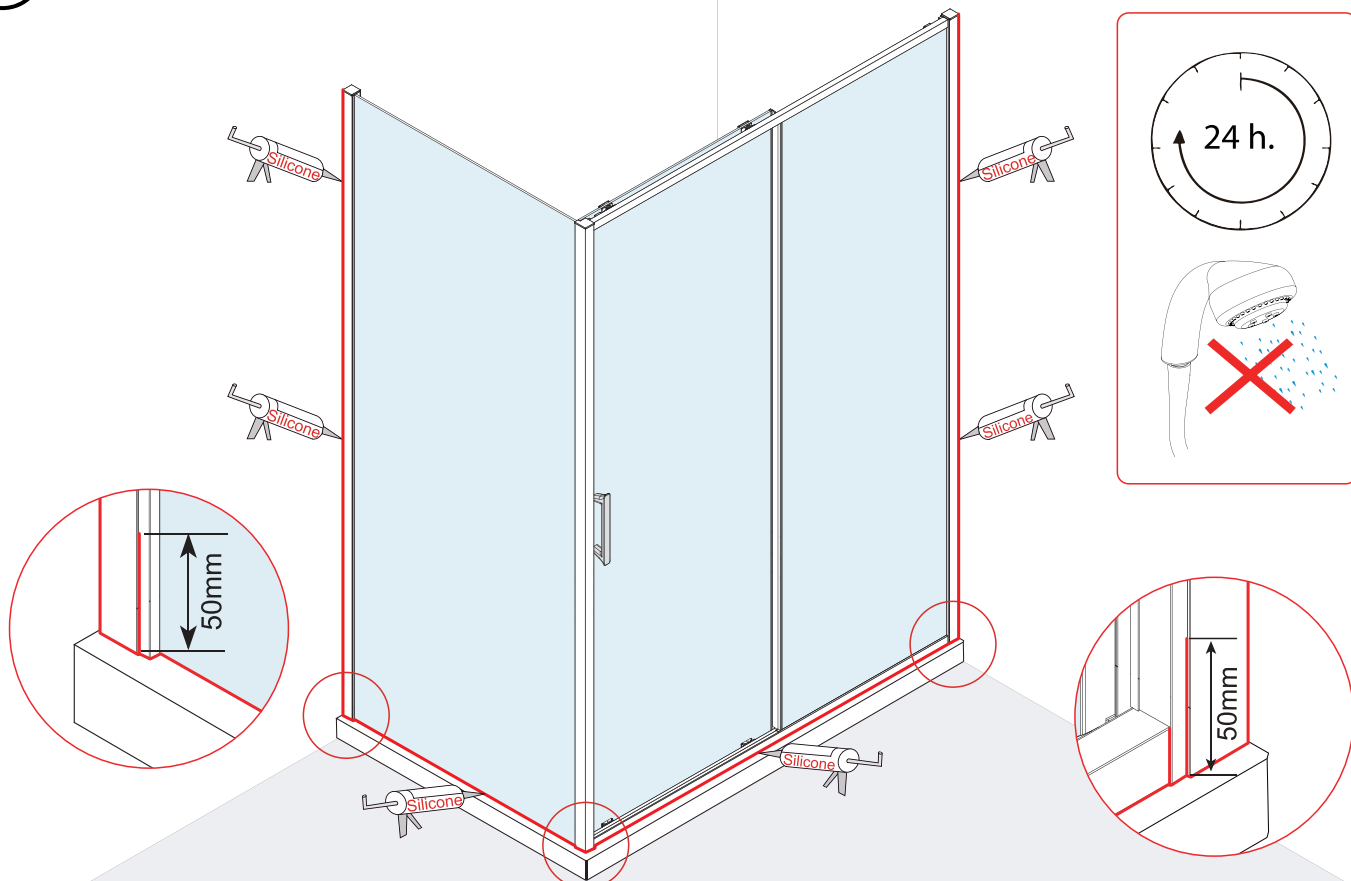



## **CLEANING**

It is important to clean your Merlyn shower door after every use. Wipe down all the glass and metal parts with a soft cloth. Do not allow lime scale to build up in hard water areas. Ensure that any residual water on the glass is removed after every use.

- Clean the glass regularly using soapy water.
- Do not use abrasive products on any surfaces.

Chrome is vulnerable to acid attack and some strong household cleaners including strong disinfectants, denture cleaners, hair dyes, wine making chemicals and photographic chemicals may contain acid. These materials may have a varying effect on the surface from black spots/streaks (which cannot be removed) to pitting the surface. Contact with these materials should be avoided.

## **TROUBLE SHOOTING**

### **Door Not functioning properly**

1. Is the tray 100% level? (step 1)
2. Do the finished tile measurements fall within the adjustment X and Y listed on ( page 4 step 2 & page 13 step 2) ?
3. Are the wall profiles plumb? (page 4 step 2 & page 13 step 2)
4. Is the frame loose? Check the locking clips are pushed fully into the slot in the frame and packaging tape has been removed? (step 7)
5. Moving panel not coming to a cushioned close, check the rollers are fitted with the extend roller arm facing the edge of the glass, not the middle. (page 8 step 9 & page 17 setp 10)
6. Check the bottom rollers are seated correctly in the channel see (page 9 step 11 & page 18 step 12) .

### **Door Leaking**

1. Was the tray adequately sealed before the enclosure was installed? (step 1)
2. Are the upright seals fitted correctly? (page 8 step 10)
3. Has the joint at the bottom of the fixed panel and the clip on the bottom of the frame been sealed correctly? (page 8 step 10 & page 18 step 11)
4. Is the edge of the moving panel closing evenly to the upright seal? If there is an uneven gap top to bottom adjust the top rollers. (page 8 step 10 & page 17 step 10 )
5. Is the door sealed correctly ? (page 10 step 13 & page 19 step 14)

To download the Declaration of Performance (DOP) for this product  
please use the link below.

<https://merlynshowering.com/aftersales-support/dop-certs/>

For further information please contact: IRL:0567791555 UK:08081011429